

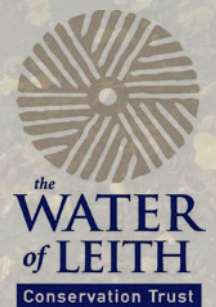

# COALIE PARK

COALIE PARK IMPROVEMENT PROJECT

DECEMBER 2021







## INTRODUCTION

## SITE LOCATION / DESCRIPTION

## LANDSCAPE CONTEXT

## PROJECT PROCESS - CONSULTATION

1. SURVEY
2. STAKEHOLDER WALKABOUT
3. COALIE CONVERSATIONS - FUN DAY

## OPPORTUNITIES + CONSTRAINTS

## LANDSCAPE MASTERPLAN

## SUB-PROJECTS:

### PLACEMAKING

CAR PARK & ENTRANCE SPACE

GATHERING SPACE

PICNICS & PLAY SPACE

COMMUNITY GARDEN WITH SKATE / TEEN SPACE

COMMUNITY ORCHARD

### INTERPRETATION AND ART

THE STORY OF WATER

LARGO PLACE SEATING & ART

LEITHLATE LIGHTING INSTALLATION

POETRY CORNER

### NATURE RESTORATION

WOODLAND MANAGEMENT

INVASIVE NON-NATIVE SPECIES MANAGEMENT

BIOMATRIX

BIODIVERSITY PLANTING

### MOVEMENT AND ACTIVE TRAVEL

SLOW SPACE & SEATING

MOVING THROUGH COALIE PARK

### WHAT'S NEXT

A PROJECT DEVELOPED BY



• EDINBURGH •  
YOUR COUNCIL - YOUR ENVIRONMENT



REPORT PREPARED BY



PROJECT SUPPORTED BY



# INTRODUCTION

## COALIE PARK IMPROVEMENT PROJECT

### CONTEXT

At the end of the tidal flow of the river lay a coal depot, railway yard and place for ship repair, which was regenerated in the 1980's and the area became known as Coalie Park. The area is an important 'blue and green space' and access route for the local community and home to a surprising variety of wildlife. But there is a great pressure on this dilapidated space and it is plagued by littering, graffiti and anti social behaviour. Leith is also the most densely populated area in Scotland and lacks quality greenspace for its residents and wildlife.

### 'COALIE CONVERSATIONS'

During this project we turned our attention on the 'blue and green space' and path network around Coalie Park. The project engaged with local people and interested groups to see what practical steps could be taken to improve the area in the short term, and what improvements they would like to see in the area going forward. The aim was to give us a prioritised list of activities and projects, which have been developed into design ideas and which inform this park improvement proposal.

### PARK IMPROVEMENT DELIVERY

There is no funding allocated and therefore the purpose of this report is to provide a holistic overview of the potential of the park and the process behind the decisions and design priorities. There is an overview masterplan and a package of discrete, thematic sub-projects which make up this whole.

Together, these interventions and improvements would make a significant impact to the quality of the space. The intention is to provide a package of information which can support future funding applications deliverable by different funds and partnerships.

### PROJECT OVERVIEW

The approach to the development of a landscape masterplan for the improvement of Coalie Park is described over three Stages, throughout the process weaving between design and community conversation and feedback.

#### Site analysis

Understanding the physical condition, opportunities, constraints and distinctive elements of Coalie Park. These should be celebrated; the park contains many landscape and heritage features which are locally significant and help connect local people and visitors to this place. This information guides the design of the park's spatial layout, and is a backdrop to the social and human experience factors which influence considerations for the park's design.

#### 'Coalie Conversations'

An ongoing process of community and stakeholder engagement and participation has been managed by Water of Leith Conservation Trust. This report describes the way a diversity of people have been involved in the realisation of a preferred option landscape masterplan, and how priorities were established. It is recognised that the conversation should continue beyond the drawing up of a park design plan to ensure this park is a meaningful, effective, well-loved greenspace for all. The project partners are mindful of avoiding gentrification of the space, and are keen that it captures the most genuine expression of local community interest.

#### Sub-project sheets

A suite of landscape enhancement projects are drawn out of the overall landscape masterplan, focusing on specific features, elements or functionality of the park.







## USER EXPERIENCE OF EXISTING PARK

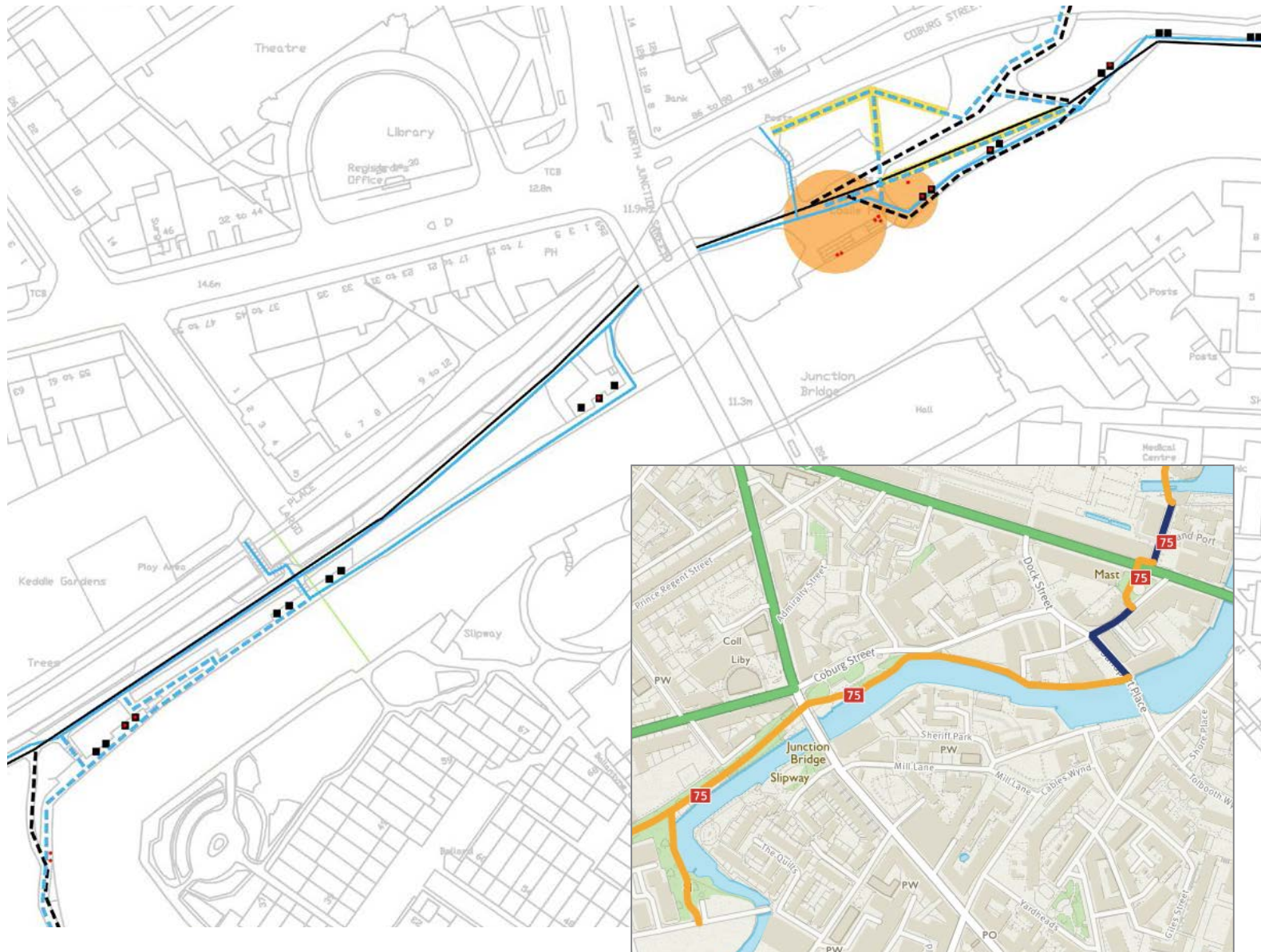

The Water of Leith Walkway, National Cycle Network 75 and the Roseburn to Leith Cycle route create the central backbone of Coalie Park; a well used cycle route linking neighbourhoods across the city.

This route is well used by both cyclists and pedestrians, resulting in it being heavily used throughout the year. Two paths run roughly parallel, one by the water's edge which is part of the Water of Leith Walkway and the upper NCN75 route which takes the course of the dismantled railway.

Users mainly interact where the park is more open, and where there are seating opportunities - both formalised at the benches, and informally on the steps leading down to the water's edge.

-  Pedestrian (primary)
-  Pedestrian (secondary)
-  Cyclist (primary route)
-  Cyclist (secondary route)
-  Desire Lines
-  Interactions
-  Benches
-  People lingering



## SITE DESCRIPTION

### FRONTAGES / BOUNDARIES

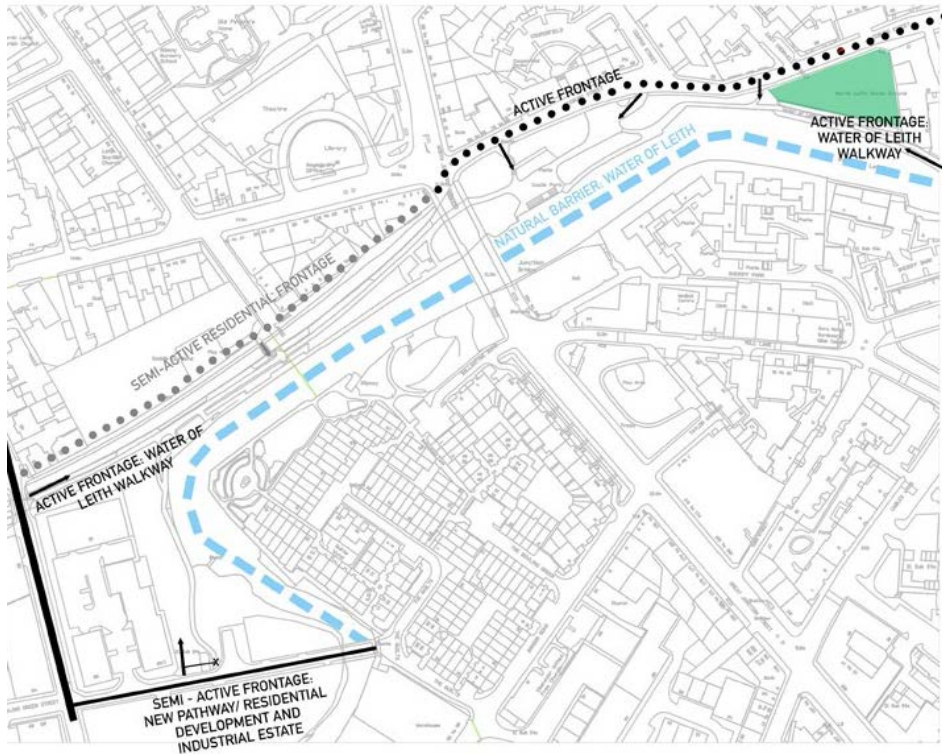

To the east, Coalie Park is bordered by North Leith Burial Ground, and to the west is enclosed by the South Fort Street Bridge and a small industrial estate. The area to the north is defined by Coburg Street and residential housing, while the southern boundary is formed by the Water of Leith and newly built residential property.

### HABITAT CORRIDORS

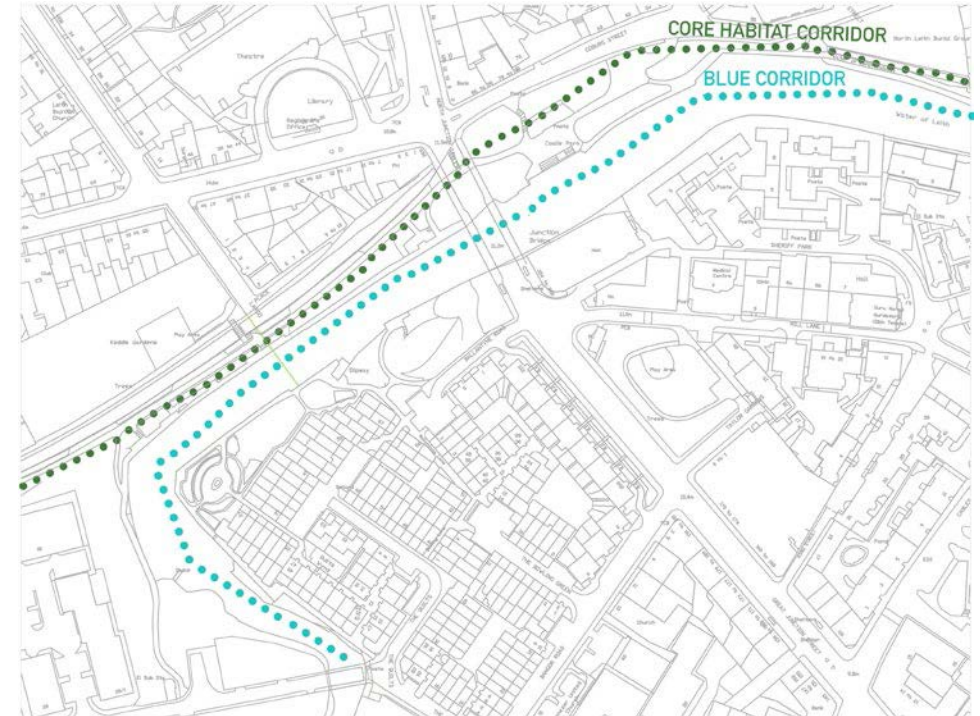

Coalie park is a vital asset to the green wildlife corridor that runs through the North of Edinburgh. The area has woodland habitat, meadow areas and blue infrastructure making it an ideal location to improve biodiversity.

Potential LBAP (Local Biodiversity Action Plan) species:

- Bat
- Otters
- Swift
- Northern Brown Argus Butterfly
- Maiden Pink Flower



## EXISTING TREE FRAMEWORK / STRUCTURE

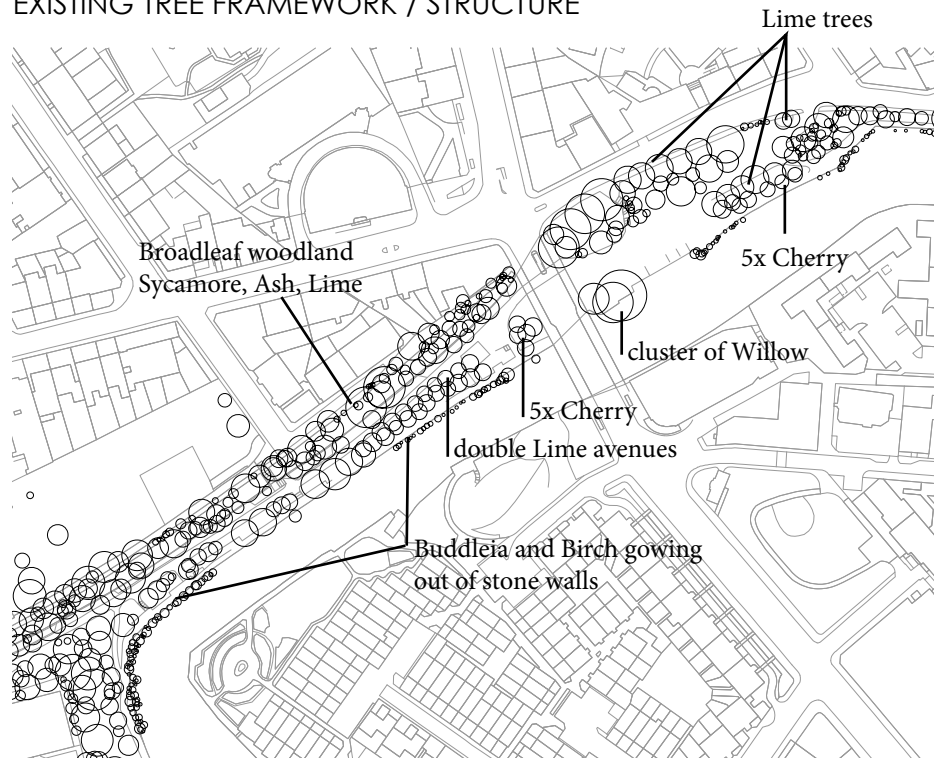

There is a well established band of broadleaf woodland defining the northern / north western slopes of Coalie Park, consisting of planted Lime trees and self seeded Ash and Sycamore. The understorey is predominantly brambles and self seeded scrub including Elder and Hawthorn.

Along the path routes there are mature Lime and Cherry trees projecting a strong arboreal character and visual structure. These trees offer a canopy of foliage, however limited variety of understorey planting due to the deep shade.

There is a large cluster of Willow spp. to the east of Great Junction Street bridge, congested with brambles and scrub. In the more open areas, the grass is close mown with some longer grassland being allowed to establish.

## TOPOGRAPHY, ASPECT AND VIEWS

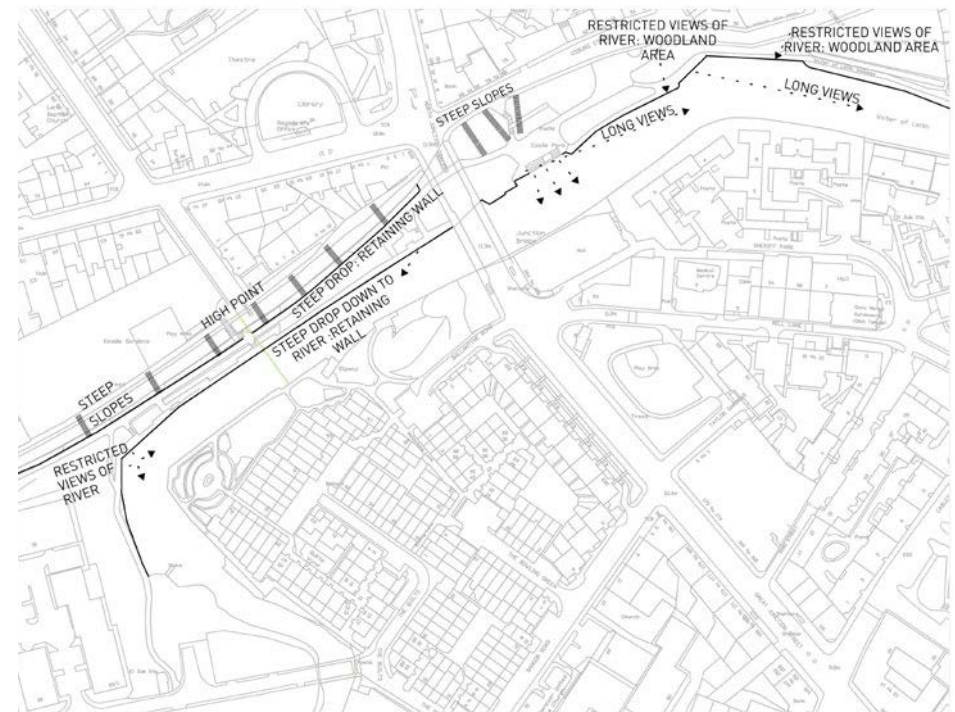

The site generally falls from the North/North West boundary of the park down towards the River of Leith through a series of level changes. These level changes above the river provides a number of viewing opportunities down and across the water.

The steepest area of the park is located to the West where the only access is by a series of stairs from Largo Place. More accessible entrances can be found to the North/North eastern side of the park from Coburg street.



## SITE PHOTOGRAPHS



Looking west along the riverside towards Great Junction Street Bridge



The existing concrete steps leading to the Water of Leith water's edge





Looking west along the Water of Leith towards Junction Bridge



Existing brick structure on west side of Junction Bridge





Looking both ways along the Lime tree double avenue (Sustrans active travel route)



Footway connecting to West Bowling Green Street, and towards bridge connecting with The Quilts

## VISUAL DESCRIPTION OF PARK USE / CONDITION

- |                               |  |
|-------------------------------|--|
| 1. Artwork embedded in paving | 9. Rubbish                               |
| 2. Old sewage structure       | 10. Waterway                             |
| 3. Mallard duck               | 11. Walk/cycle way                       |
| 4. Bike attached to post      | 12. Steps leading down to water          |
| 5. Access to park             | 13. Poorly maintained bench              |
| 6. User groups                | 14. Underpass                            |
| 7. Signage                    | 15. Entrance to Coalie park and car park |
| 8. Desire line (cycling)      |  |





1



2



3



4



5



6



7



8



9



10



11



12



13



14



15



POLICY / CONSTRAINT	DESCRIPTION	DESIGN IMPLICATION / POTENTIAL
Notable Habitat - A1.1.1	Notable habitats - Woodland, Broadleaved, Semi-natural	Greenspace corridor and linkages, wider infrastructure and management of habitat type. Active and positive woodland management, including potential for a replanting programme.
Within 50m Of A Public Right Of Way	Public Rights of Way	Part of an important active travel network. Consider how this route could be made safer, more inclusive; better sign posting and lighting.
Core Paths	Within 50m of a core path	Review core paths plan to identify any aspirational links being promoted, foster links with adjacent greenspaces and active travel routes. Fully develop potential of the Sustrans route (National Cycle Route 75) and work in partnership with Sustrans on placemaking objectives.
The Water Of Leith LBS	Local Biodiversity Site	Review LBS for species / habitats which the park design proposals could support or enhance.
Open Space Audit	Classification in 2009 Open Space Audit: green corridors	Highlights the importance of the nature of linear greenspaces
Proposed Linear Local Biodiversity Site	Proposed Linear Local Biodiversity Site	Integrate with adjacent greenspaces at Keddie Park and the Quilts, to connect habitats and contribute to the wider green infrastructure network.
Radon Potential Class 1	Radon Potential, as identified in the Health Protection Agency (HPA) and British Geological Survey (BGS) data	Ground likely contaminated, impact on uses of site for community growing, productive planting (orchards, edible hedgerows etc.). Soil analysis required if these are part of the design proposals taken forward.
SEPA flood mapping	High to medium risk of river flooding	No risk of surface or coastal flooding as identified on the SEPA flood maps; some areas at risk of medium or high risk river flooding. Design finishes and surface treatments accordingly to allow water levels to rise and fall. Potential to use vegetation to slow surface water run off, and roots to stabilise slopes and embankments.





Sycamore



Lime



Cherry



Willow



Overhang



Buddleia

## TREES AND WOODLAND

The trees and woodland at Coalie Park are part of the special landscape character, and offer something unique and valuable in this dense urban neighbourhood. The sense of 'wildness' and escape which the mature trees lend is described repeatedly by many different user groups as a key feature and to be protected as the park is improved.

## ISSUES AND CONSIDERATIONS

- The diversity of the broad-leaf woodland is limited due to the self-seeded species which dominate with heavy canopy cover; Sycamore and Ash shade the woodland floor.
- The Ash at Coalie Park is at risk of removal as part of positive management for Ash Dieback (*Hymenoscyphus fraxineus*, a chronic fungal disease of ash trees characterised by leaf loss and crown dieback in infected trees). Trees are being removed to avoid spread and costly removal of affected trees. Approach and best practise should be discussed with the relevant Council Officer.
- The Lime avenue is very mature, casting a dense shade and thereby reducing potential for species diversity and habitat mosaic.
- There are clusters of planted cherry trees, forming attractive stands but which would benefit from sensitive management to lift / thin crowns.
- A cluster of Willow to the east side of the bridge offers a valuable habitat, as it overhangs the water offering shelter and refuge to river fauna. The understorey is a dense scrub of brambles and nettles and in the north an area of rough grassland.
- There are a lot of overhanging branches around the car park, in places blocking street lighting and negatively affecting the sense of safety.



## IMPROVE THE FLOW OF USER MOVEMENT

The current layout of Coalie Park blocks the natural flow of users, as seen in various desire lines, short cuts, and conflict points between different users. Is there an opportunity to develop a continuous route that enables free pedestrian and cyclist movement both along the waters edge and down to the river? Could a new routing transform the park and mirror the movement of the water?



## RE-ESTABLISH THE CONNECTION WITH THE WATER OF LEITH

The Water of Leith was an important resource in the development of the city during industrial times. However, recently the peoples' connection with the water has been forgotten and its value lost. There is an opportunity to develop the park's existing features, for example by increasing usability of the lower walking route and improving the condition and range of seating areas.

Perhaps new features like this could encourage users to reconnect with the river, while also offering new educational and wellbeing opportunities? Perhaps more could be made of the natural environment in the heart of the city, and the diversity of water fowl living here?

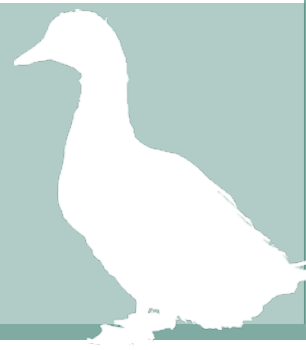

## ENHANCE BIODIVERSITY

The existing greenspace resources of Coalie Park would greatly benefit from enhancement and diversification of vegetation. How could the existing vegetation be better managed for habitats and biodiversity? It is important that these enhanced areas directly connect with the wider green corridors across the city, for people and nature. This could include being a catalyst for change at Keddie Park, or linkages across the bridges to Coal Hill and the Quilts, or by introducing novel installations such as floating habitat installations.





## CONSTRAINTS

### EXCLUSIVE ACCESS

The park is steeply banked on the north side, and the whole northern portion of Coalie Park is a wooded 1:1 gradient slope. This results in limited access from Coburg Street, possible only by steps leading off the pavement through the steep banks with heavy vegetation cover. The only ramped access is at the car park off Coburg Street, and when approaching the park from the east or west along the dismantled railway route. Pathways vary in width; with some sections of the park being very narrow, sandwiched between the slope and the river which is a particular problem in areas where there is a high number of users.

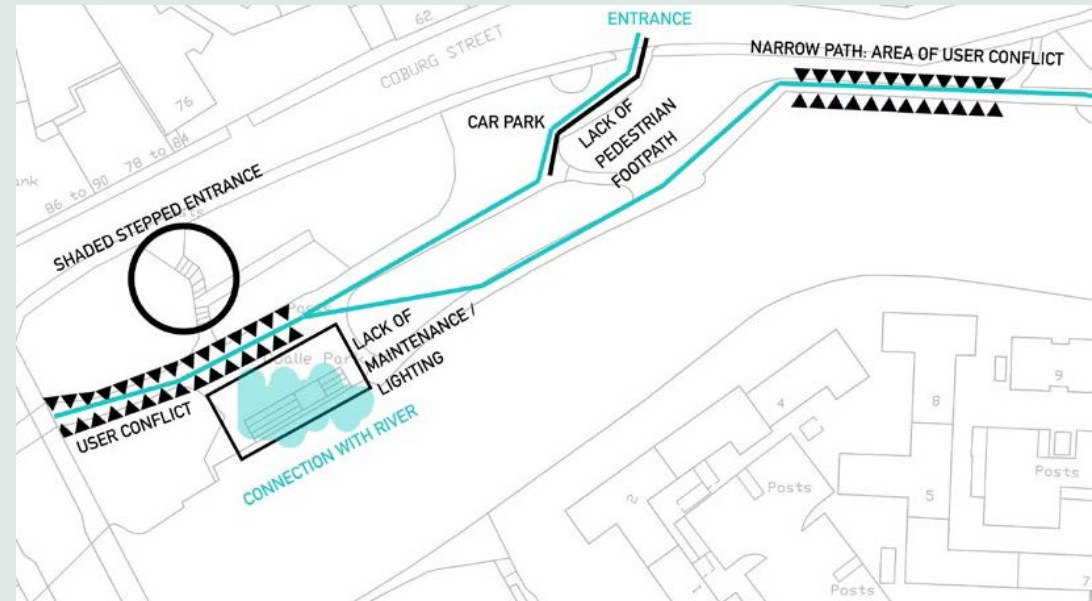

### PERCEPTIONS OF SAFETY

Shade in the day, darkness in winter - some of the key routes lack sufficient lighting and small hidden spaces are present within Coalie Park. It has been noted by members of the public that the park does not feel like a safe space to visit at night.

### CONFLICT BETWEEN USER GROUPS

There is conflict between pedestrians and cyclists, most notable in speed of travel. This stems from narrow pathways that are present in some areas of the park, particularly the Eastern side.

### MAINTENANCE

There is an overall lack of maintenance of both hard and soft landscaping. This is obvious when observing the structures, facilities, vegetation, and environmental cleanliness of the park.





A PROCESS OF ONGOING

# ENGAGEMENT



# COALIE CONVERSATIONS

A PROJECT PROCESS FOR PARTICIPATORY PLACEMAKING

## WHY ARE WE CONSULTING?

Consultation is an ongoing process - a deeply rooted part of this project. The Water of Leith Conservation Trust initiated an engagement and consultation process, which ran throughout the project and design development, informing and guiding the decisions made at each stage.

The project is based on the discussions and findings from this process of engagement with local people and interested groups. It provided the basis for deciding what practical steps should be taken to improve the area in the short term and identified what improvements people would like to see in the area going forward.

The aim behind this collaborative, user-led approach is to give the project development team a prioritised list of actions and activities we can take forward to this improvements plan, which are truly wanted and needed by local people.

## AIM

By talking and engaging with the local community and users of Coalie Park, we believe the resulting design for the park is one celebrates its history, heritage and natural environment assets. The aim is to create a space local people want and need.

## TIMELINE : PROJECT PROCESS

- 1 SUMMARISE LANDSCAPE FEASIBILITY STUDY (2019)
  - Prepare materials for consultation and feedback, based on the feasibility study report.
- 2 'COALIE CONVERSATIONS' (SPRING 2021)
  - Initiate 'Coalie Conversations' with social media, local poster campaign, and an online survey.
- 3 SURVEY FINDINGS (SUMMER 2021)
  - Review and analyse findings from survey and comments, to produce a list of actions and project priorities.
- 4 'COALIE COLLECTIVE'
  - Form a partnership group of local organisations and landowners to drive the project forward.
- 5 UPDATED LANDSCAPE DESIGN
  - Revised park proposals to reflect Coalie Conversations process and findings, and incorporate partnership projects.
- 6 FUN DAY - ENGAGEMENT EVENT
  - Fun Day in Coalie Park, with exhibition of ideas and activities, to discuss the updated park design ideas.
- 7 COALIE COLLECTIVE REVIEW
  - Presentation of final draft park improvement plan for stakeholder feedback and inputs.
- 8 PARK DESIGN PLAN
  - Plan recording aspirations and priorities for the enhancement and design of Coalie Park.
  - Record of project process, engagement, and participatory placemaking events and activities.
  - Park design plan identifying themes and sub-projects to realise a holistic improvement plan
- 9 IMPLEMENTATION AND NEXT STEPS
  - Make applications to funders, for thematic projects or stand-alone features.
  - Secure relevant land owner permissions
  - Make planning application for sub-projects as required
  - Develop details with project partners and delivery collaborations.



## 1. COALIE CONVERSATION ONLINE SURVEY

Open from February to March 2021, the 'Coalie Conversation' was a simple online Survey Monkey consultation on the park enhancement and improvement proposals originally developed for the Landscape Feasibility Study (prepared 2019).

A summarised version of the landscape feasibility study was presented, and questions to explore these ideas were designed to provide priorities to take a park design forward.

The survey was promoted on social media, via local groups and using on-site posters (no face to face due to Covid restrictions at the time). A range of images, posters and outline proposals supported the survey, which received 454 responses.

Almost all responses were from local people due to lock down. An infographic of the discussion and key findings was drawn together, based on analysis of all the responses received.

### IDEAS + SUGGESTIONS TO CONSIDER

- Outdoor play, sport and active travel improvements which are more than the usual playparks, skateparks or exercise machines.
- Plan for park improvements which work day and night for users and local residents.
- Connections to Sandport Place, Keddie Park, The Quilts, North Leith Burial Ground.
- How do we engage all park users including those considered 'antisocial'?
- How to improve the space under the Bridge and at the brick structures, while keeping the wild-ness, habitats, and peaceful setting?

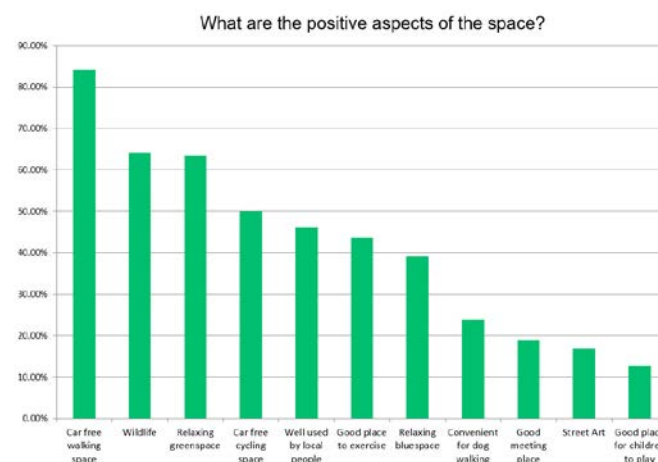
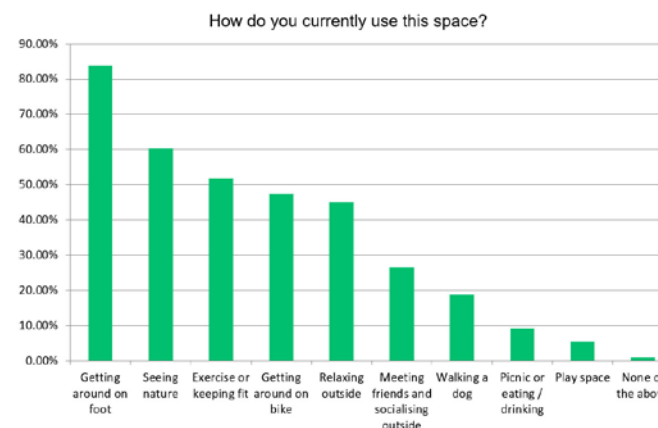
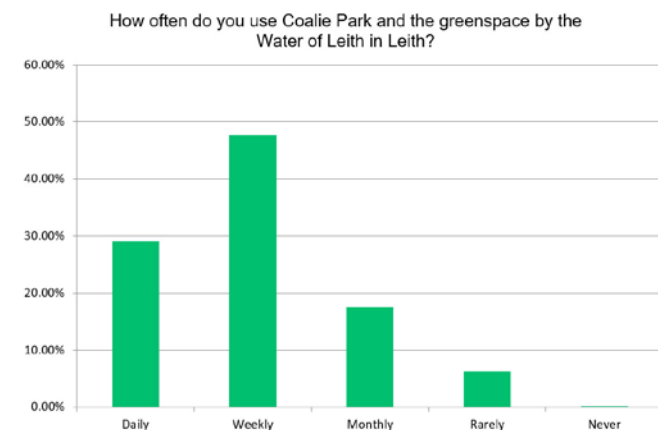



## 2. COALIE COLLECTIVE STAKEHOLDER WALKABOUT

A gathering of representatives identified by the WoLCT as the 'Coalie Collective' stakeholders got together at an afternoon event. The organisations attending included:

- City of Edinburgh Council (Natural Heritage, Parks and Greenspace)
- Scottish Water
- Friends of the Water of Leith Basin
- SOSLeith
- LeithLate
- Leith Harbour and Newhaven Community Council
- Citadel Youth Project.

The aim was to identify and form a 'Coalie Collective', a group of stakeholders and representatives who would be involved in the formation of the improvement plan and the implementation of the resulting park design proposals.

At this first collective meeting, held at Custom House on the 31st August 2021, the results of the 'Conversation' (online survey) were presented by the Water of Leith Conservation Trust, and a discussion followed of the issues raised. After a reflective feedback and formative comments by the Collective, a site walkover helped to see first-hand some of the issues and inform further discussions.

Overall the Collective was supportive of the proposals as they were developing, but some specific comments were made which in turn helped inform the updated design plan to be shown at the October engagement event and Fun Day.

***"The project should value and protect the special qualities of wildness and nature in the heart of the city."***

***"History and interpretation of Coalie Park's heritage shouldn't be lost, but the project should link in with the Spirit of Leith and the Living Memories initiatives."***

***"There is an opportunity for visual continuity in the palette of materials, and spatial continuity in the linking of other nearby greenspaces and active travel connections."***

***"Citadel's use of the green and blue spaces as part of their programme of youth activity is supported, and a permanent site for their equipment storage should be integrated to the park enhancement proposals"***

***"The woodland canopy, mature trees and sitings of wildlife are invaluable and at the core of Coalie Park in the 21st Century."***





### 3. COALIE CONVERSATION 'FUN DAY' EVENT

On 3rd October 2021, WoLCT hosted their first event at Coalie Park in Leith – to raise awareness of this project to improve the area, gain feedback on the plans so far from local people and have some fun.

With a 'Coalie Conversation' tent, WoLCT presented ideas for the future. There was lots of interest and dozens of suggestions and feedback ideas were collected to be reviewed and incorporated in the designs. Citadel Youth Centre and Edinburgh Wheels project were also on hand to explain how the area could be used by young people on land and in the water.

The WoLCT practical volunteer team was on hand to make the day fun too. With wildflower bulb planting, a river clean-up game and guess the weight of the litter challenge (collected in the park that morning). HMS Litterpicker was also cruising the basins collecting litter. The fundraising volunteers did a great job with a Plant Sale, Mystery Bottle tombola and book sale – all raising £300. Outdoor learning was also featured with a gazebo of natural objects for children to explore and a fun treasure hunt which 40 families used to explore the park. Finally the heritage of the area was explored with a display of old photos and two guided walks.

It is tricky to tell how many people took part and its a busy area of the walkway, but project partners estimate that around 300 directly engaged in the activities and presentations with a further 300 taking a passing interest.

The reaction was overwhelmingly positive and supportive of the park improvement project.



**“I’d love to see the space even more animated. Events taking place with a real sense of community.”**

**“Very interesting plans. The idea of mixed uses is essential to create a safer, more accessible space for everyone. There is a good balance of exercise (skateboarding, walking and cycling routes) and relaxation without replacing the history of the place”**



“

*I'd like to see art installations*

“

*Work with local social enterprises*

“

*There is a good balance of exercise and relaxation without replacing the history of the place.*

“

*The idea of mixed uses is essential to create a safer, more accessible space for everyone*

“

*I'd like there to be more planting of pollinator friendly flowers and bulbs to encourage nature and biodiversity*

“

*More lighting to allow safe dog walking in dark evenings, and consider women's safety issues*



#### 4. COALIE COLLECTIVE REVIEW

On the 29th November 2021, the Coalie Collective stakeholder group and other emergent interested organisations and individuals who engaged with this process were invited to provide input and review of the final draft park improvement plan. 12 individuals and organisations were represented at this online feedback workshop call.

This was held as an online discussion forum, where the proposals were presented and feedback was gathered. WoLCT feels it is critical the proposals genuinely and fully reflect the aspirations and potential of the changes which can be delivered in partnership with the Coalie Collective, and as such wanted to ensure the designs and strategies reflect these priorities.



COALIE PARK MASTERPLAN

# DESIGN



## DESIGN OBJECTIVES

### SUMMARISED FROM CONSULTATION

The participatory place design and planning process has allowed the project team to identify clear objectives which guide the park design. These are overarching commitments in the approach to the improvement plan, and which inform the proposals presented on the following pages.

- To bring the vegetation into active, positive management for biodiversity, and for a sense of safety, wayfinding and park placemaking.
- To make this place work for as many people as possible, by installing new benches, bins and improving the path surfacing.
- To bring together the existing spaces scattered along this linear 'park' by giving them functions as a series of sub-projects, celebrating local heritage, wildlife and activity.
- To promote and encourage active travel by waymarking and improving the loop route (railway and riverside routes linked) and light routes where appropriate.

### SUMMARISED FROM POLICE FEEDBACK

Key messages from site visit with the police:

- Lighting is a bonus, with low level and ground light considered suitable to enhance the existing lighting provision. Recommend trimming back trees in areas around existing lights.
- Poetry Corner is a difficult spot to manage, but has potential due to sightlines from car park. Recommend new seating and to make the space visible from the road.
- Improvements to the brick structures would make the area feel less threatening. Include new replacement seating, trellises/ planting up the walls to change the atmosphere and character to a more natural greenspace. Low level lighting could also improve sense of safety, and the walking route should perhaps avoid the narrowest sections.
- At the Great Junction Street bridge the hole at the side of the bridge could be blocked up, and there shouldn't be benches here. Positive feedback on a mural at this location, to inspire art rather than tagging.
- Install more bins.

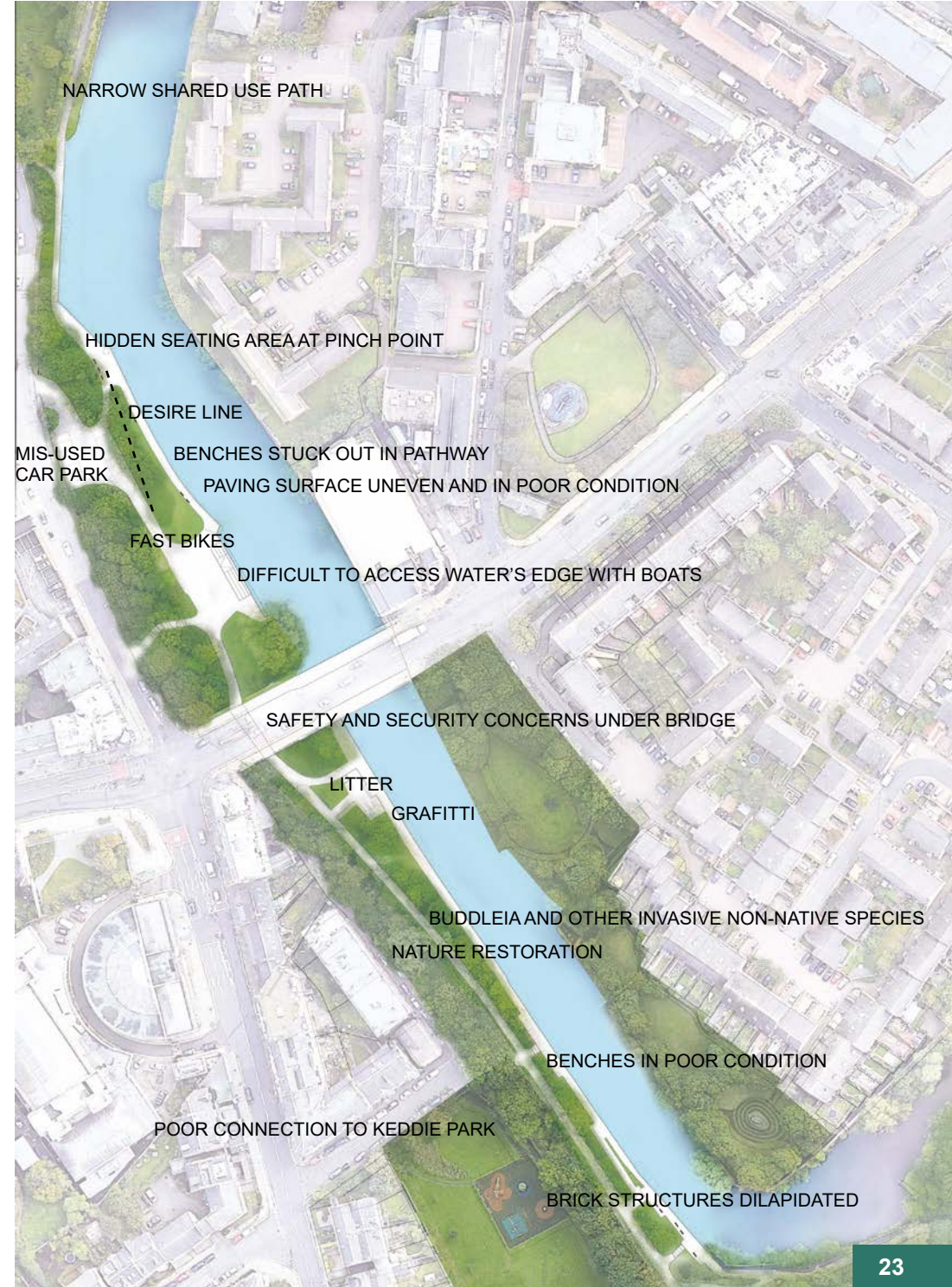

Site plan as existing <N



## COALIE PARK IMPROVEMENT PROJECT

A community led project to deliver place improvement for citizens and nature in Leith. Including 5 placemaking projects, 800m<sup>2</sup> path upgrading, 4 arts / interpretation installation and restoration and management of nature habitats in the water and woodland areas.

### PLACEMAKING

- ① Car park and entrance space
- ② Gathering space
- ③ Picnics & play space
- ④ Community garden with skate / teen space
- ⑤ Community orchard

### ART AND INTERPRETATION

- ⑥ The Story of Water
- ⑦ Largo Place seating and art
- ⑧ LeithLate lighting installation
- ⑨ Poetry Corner

### NATURE RESTORATION

- ⑩ Woodland management
- ⑪ Invasive Non-Native Species management
- ⑫ Biomatrix
- ⑬ Biodiversity planting

### MOVEMENT AND ACTIVE TRAVEL

- ⑭ Slow space & seating
- ⑮ Moving through Coalie Park



Site plan as proposed <N



## DESIGN RATIONALE

### A LOOP WALKING ROUTE

---

A measured walking route within Coalie Park, marked by public art installations at either end, and with thermoplastic paint applied directly to the bituminous macadam sections of path showing distance, marking features, and interpreting the walking experience.

### BIODIVERSITY ENHANCEMENT / CONNECTIONS



As a linear park, Coalie offers valuable opportunities for greenspace linkages and habitat connectivity. The planting and habitat enhancements proposed (Biomatrix, woodland under-planting) will increase biodiversity value and network. As far as possible, existing trees should be protected in place. Growing opportunities are created for example with the integration of raised bed planting areas at the gathering space, the brick structure, and the entrance space.

### IDENTITY AND SENSE OF PLACE

The proposals for Coalie Park identify locations for clusters of furniture, activity and facilities such as benches, bins, lighting, public art, interpretation, and the Citadel outdoor activity storage container. These becomes nodes' and help organise the park and give the user a rhythm moving through the space. They also act as meeting spaces, points of interest, or aid recognition of location, while adding comfort and safety to the park. The spacing of benches at no more than 400m apart is considered good practice place design in line with DDA (Disability Discrimination Act) recommendations.

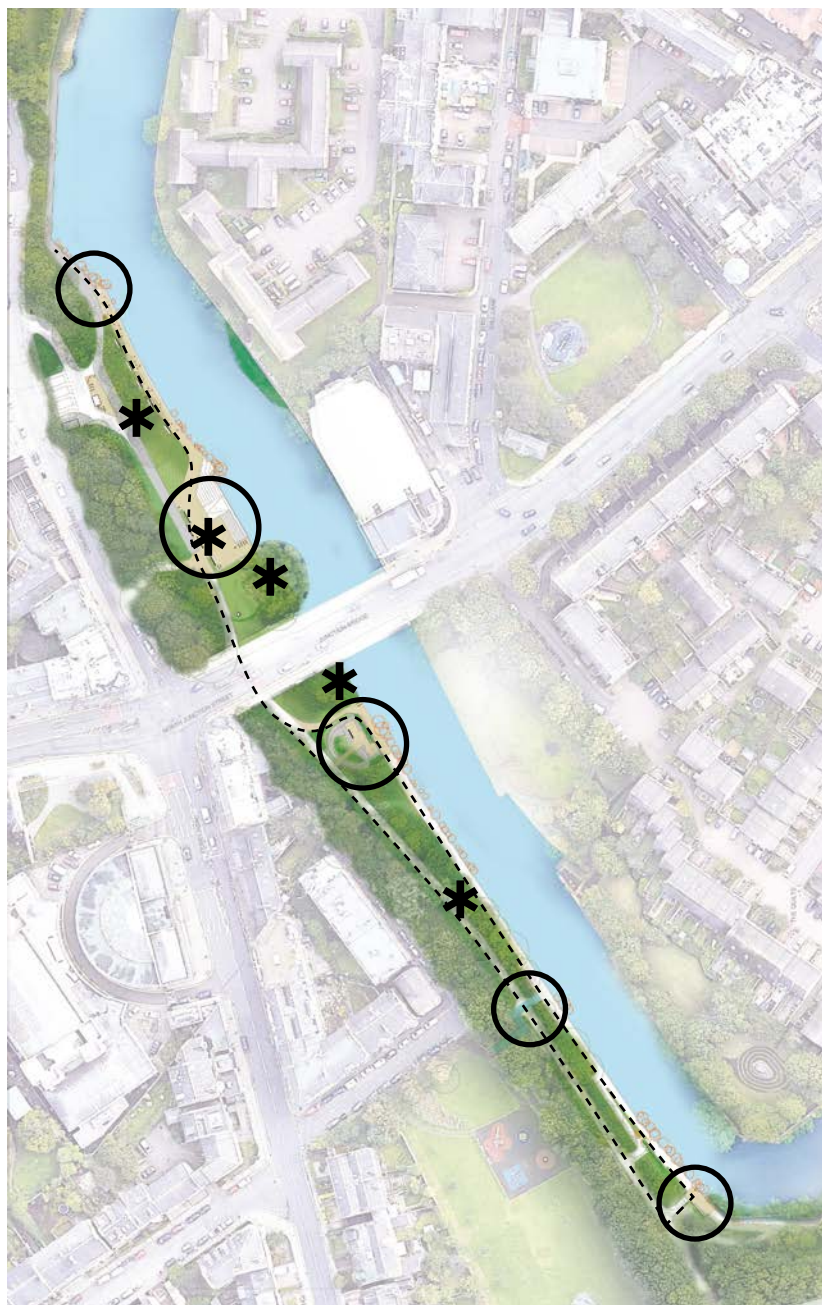

<N



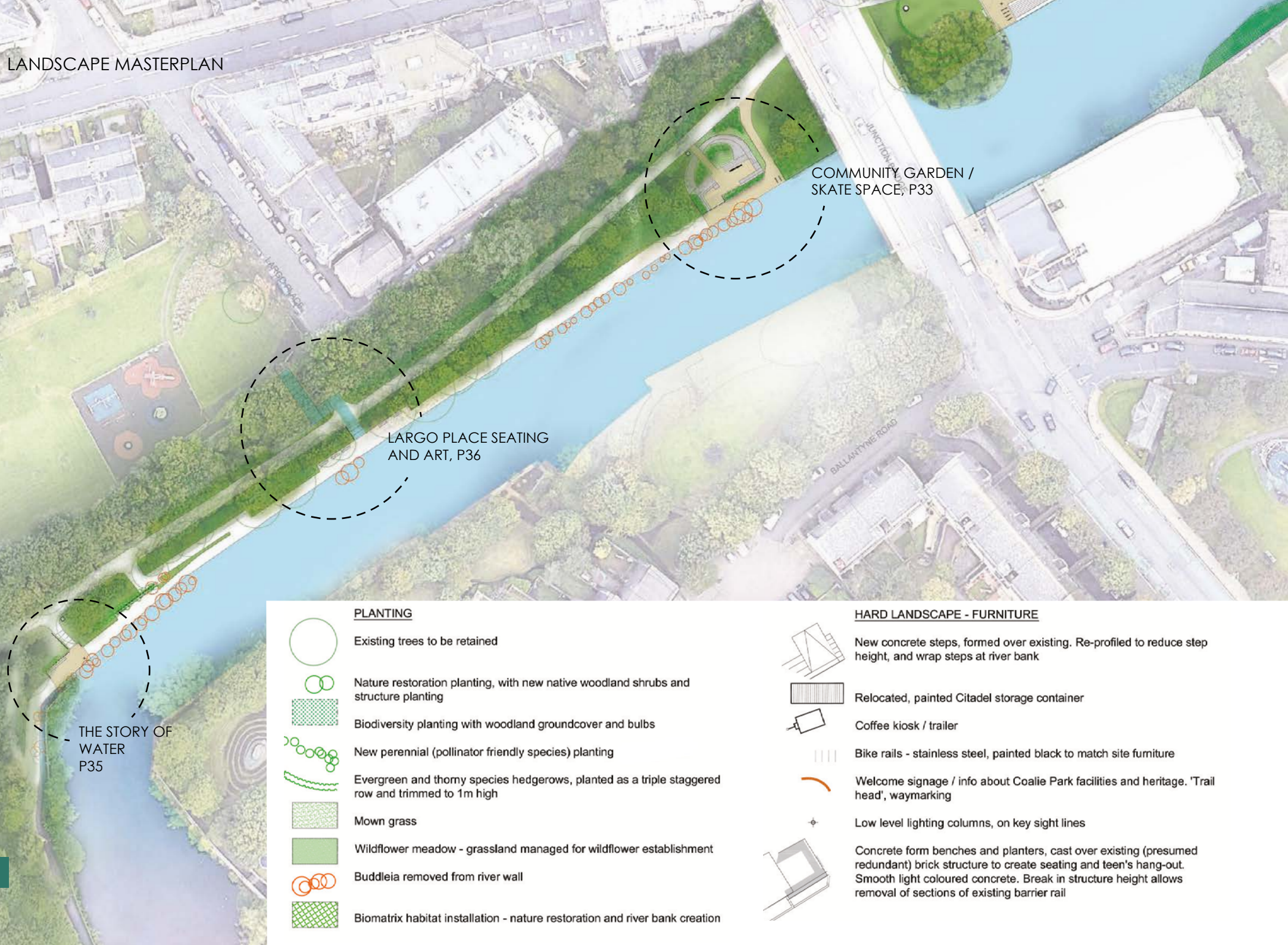







**PLANTING**

-  Existing trees to be retained
-  Nature restoration planting, with new native woodland shrubs and structure planting
-  Biodiversity planting with woodland groundcover and bulbs
-  New perennial (pollinator friendly species) planting
-  Evergreen and thorny species hedgerows, planted as a triple staggered row and trimmed to 1m high
-  Mown grass
-  Wildflower meadow - grassland managed for wildflower establishment
-  Buddleia removed from river wall
-  Biomatix habitat installation - nature restoration and river bank creation

**HARD LANDSCAPE - FURNITURE**

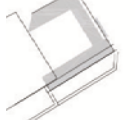
-  New concrete steps, formed over existing. Re-profiled to reduce step height, and wrap steps at river bank
-  Relocated, painted Citadel storage container
-  Coffee kiosk / trailer
-  Bike rails - stainless steel, painted black to match site furniture
-  Welcome signage / info about Coalie Park facilities and heritage. 'Trail head', waymarking
-  Low level lighting columns, on key sight lines
-  Concrete form benches and planters, cast over existing (presumed redundant) brick structure to create seating and teen's hang-out. Smooth light coloured concrete. Break in structure height allows removal of sections of existing barrier rail



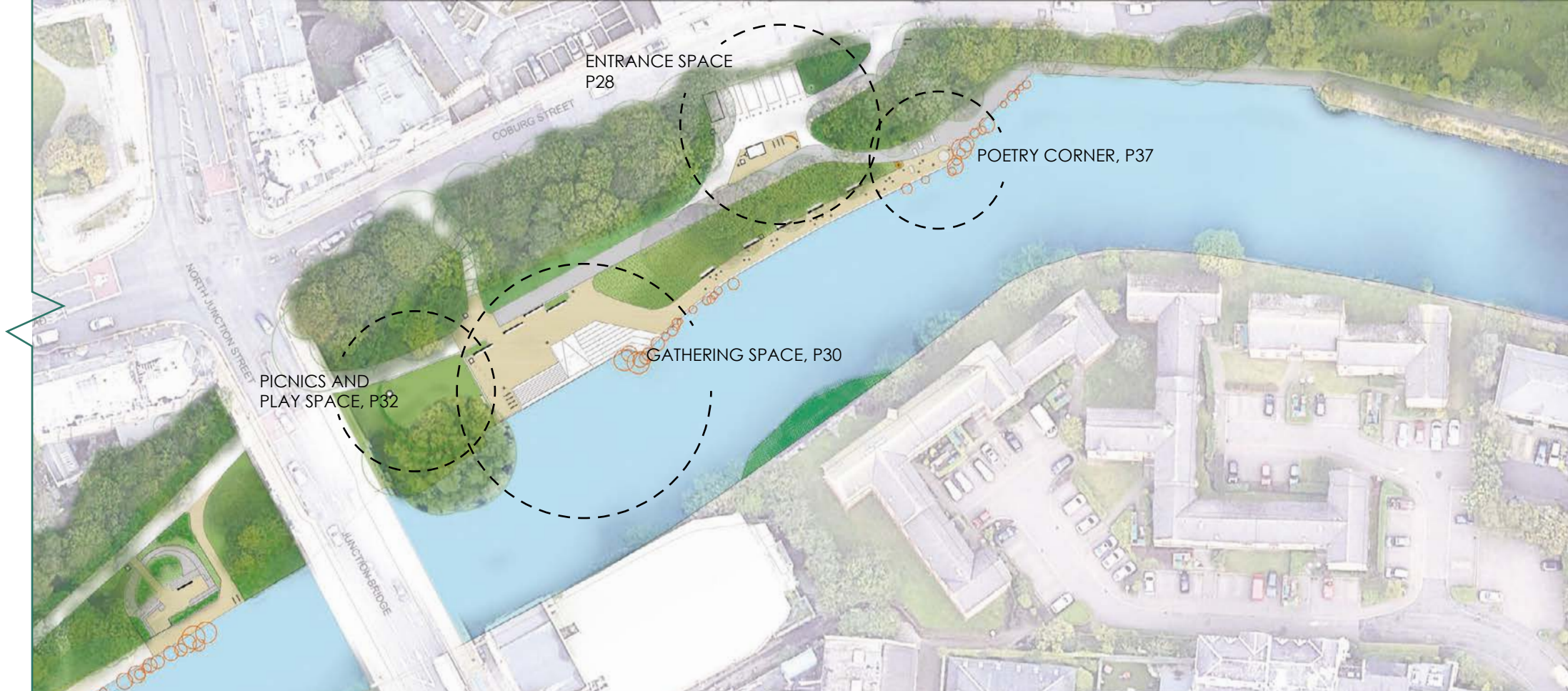





#### HARD LANDSCAPE - SURFACING

↑ N | NTS

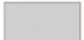
-  Stainless steel benches, painted black
-  Reclaimed railway seating, painted by Citadel as part of a community public art project
-  Interpretation panels affixed to existing brick walls
-  Climbing plant trellises affixed to existing brick structures
-  Paint all railings black
-  Install new handrails to improve accessibility at existing steps between upper and lower walkways

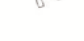
-  Resin bound gravel - warm natural stone aggregate
-  Resin bound gravel - coloured, to design and specification of artistic installation / briefing
-  Bituminous macadam surfacing to cycle track route
-  Concrete form through soft creating skate loop, detailed design by others
-  Relocated poetry stones, into resin bound gravel / bituminous macadam made good areas
-  Marking - Install in-ground markers within existing cobble area to define accessible parking spaces x4



## 1. CAR PARK + ENTRANCE SPACE

Reduction in parking is based on the findings of public survey and stakeholder feedback, which found that very few people using the car park are in fact users of Coalie Park. There was a considerable response to what a waste of park space the car park was, and users would prefer facilities and features which relate to the park / natural greenspace.

1. Removal of approximately 5 unmarked parking spaces, to site park furnishings and improved circulation design reducing conflict between cyclists and pedestrians. Mark out 4x accessible sized parking spaces against the wall, using in-ground markers and identify as accessible (blue badge) spaces.
2. Coffee kiosk / trailer, a small mobile coffee shop could serve as a hub within this entrance space off Coburg Street, so people can have even more reasons to explore and enjoy the park.
3. Citadel's outdoor equipment storage container located to create a setting in partnership with the Coffee trailer. Painted on East facing elevation with a Coalie Park 'welcome' graphic and interpretive mural indicating the route the railway tunnel took and celebrating the site's railway connections.
4. Wayfinding and interpretation panel installation, with content sharing history and heritage of Coalie park, and sign-posting to the other public art / heritage interpretation features in the park.
5. 3x LED post-mounted lights, e.g. MACARON luminaires. Lighting agreed with street lighting, and design and installation to an adoptable standard ensuring long term maintenance.
6. 3x new bike racks.
7. Native bulb and wildflower planting under existing trees.
8. New edge alignment to maximise space for planting, improve definition of vehicular movement and use of space. Build drystone retaining wall, delivered as a community project with the Scottish Association for Drystone Wallers. Planted up with woodland biodiversity species mix (see p39)
9. 2x new litter bins.
10. Space re-surfaced with resin bound natural stone aggregate to create a smooth inclusive access space. Remove existing bollards to prevent trip hazard, and use colour, flush kerbs and materiality to define spaces. Space at Coffee Trailer for queuing, serving, waiting.
11. Entrance heritage signs upgraded as per others along Water of Leith Walkway,

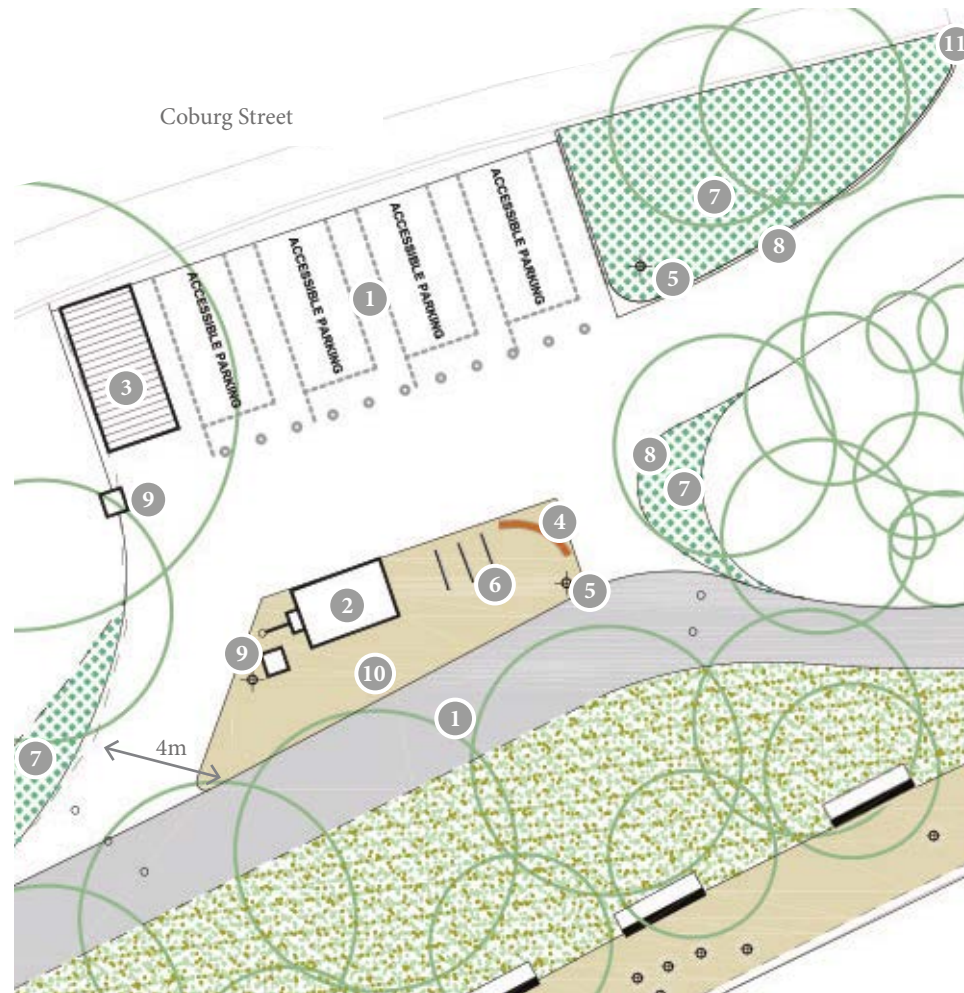

^ N 1:250 (A4 printed pages)

Re-organisation of the different speeds of user, from 'fast' through route users such as commuters on bicycles to slower meandering riverside walkers and intergenerational groups. See project 15 on p44 for details and management of these routes.

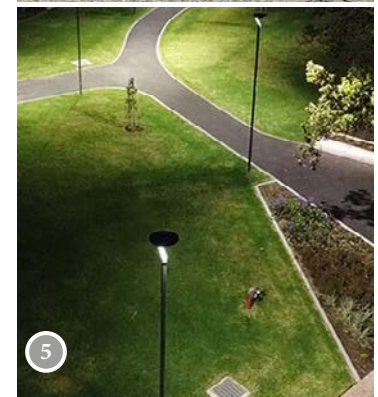
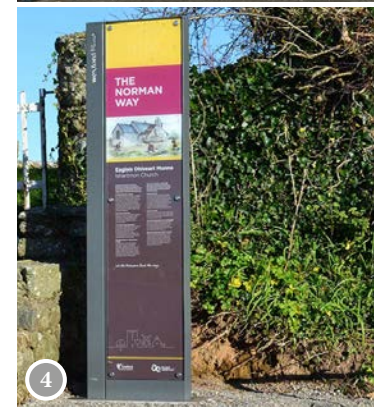
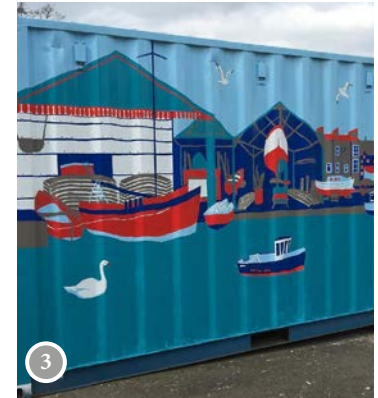





Existing



Proposed



## 2. GATHERING SPACE

Designed to offer a flexible events and meeting space, supporting the existing use by Citadel for access to the river for watersports and creating a place where people can meet, relax, and watch the comings and goings at Coalie Park. This space should feel open, inclusive, safe, and clean. It adapts the existing feature, a known meeting space in Leith, into somewhere which is inviting and yet functional.

Bicycle users are encouraged to keep to the north of the space, through the different path surface material and colour, and thereby bypassing this slower passive area.

1. Planters to delineate space, giving it edges but still allowing easy movement between and through spaces. Planting would be managed by WoLCT as part of monthly clean up events and programme of hands-on volunteering.
2. Long benches offer a spot to bring school / nursery children and use Coalie Park as an outdoor learning resource. Some of these benches should have backrests and arm rests, to ensure inclusive use. They are proposed as solid-form concrete to be durable and robust, and not become a maintenance or replacement burden while being warmer than metal. Working with Edinburgh Wheels or another local design and build initiative which focuses on employability and re-skilling local youth, the benches could be made from diverted excess concrete from nearby construction works, in keeping with the concrete step re-profiling to visually connect this gathering space as a whole.
3. Reconfigure concrete steps to wrap around the point where the river bank opens up and is accessible. South facing, these widened steps create informal seating opportunities. Civil engineering detailed study required. Use recycled / diverted excess concrete wherever feasible or practicable.
4. Ramp length doubled; gradient halved to facilitate access for watersports.
5. Realign path to smooth gradient, widen, and resurface with resin bound natural stone aggregate to create a warm and friendly, and inclusive access space wrapping around this area. This is non-toxic stable material providing natural slip resistance.
6. Lighting columns x3, to use energy efficient LEDs. Install with a colour filter to limit impact on nocturnal insects. Designed and installed in agreement with street lighting at the Council, for ongoing maintenance.
7. 2x new litter bins, addressing key comments from the public to ensure the 'small things are done right'. These will require approval with the local authority; the need was strongly represented in feedback.
8. 4x new bike racks installed.

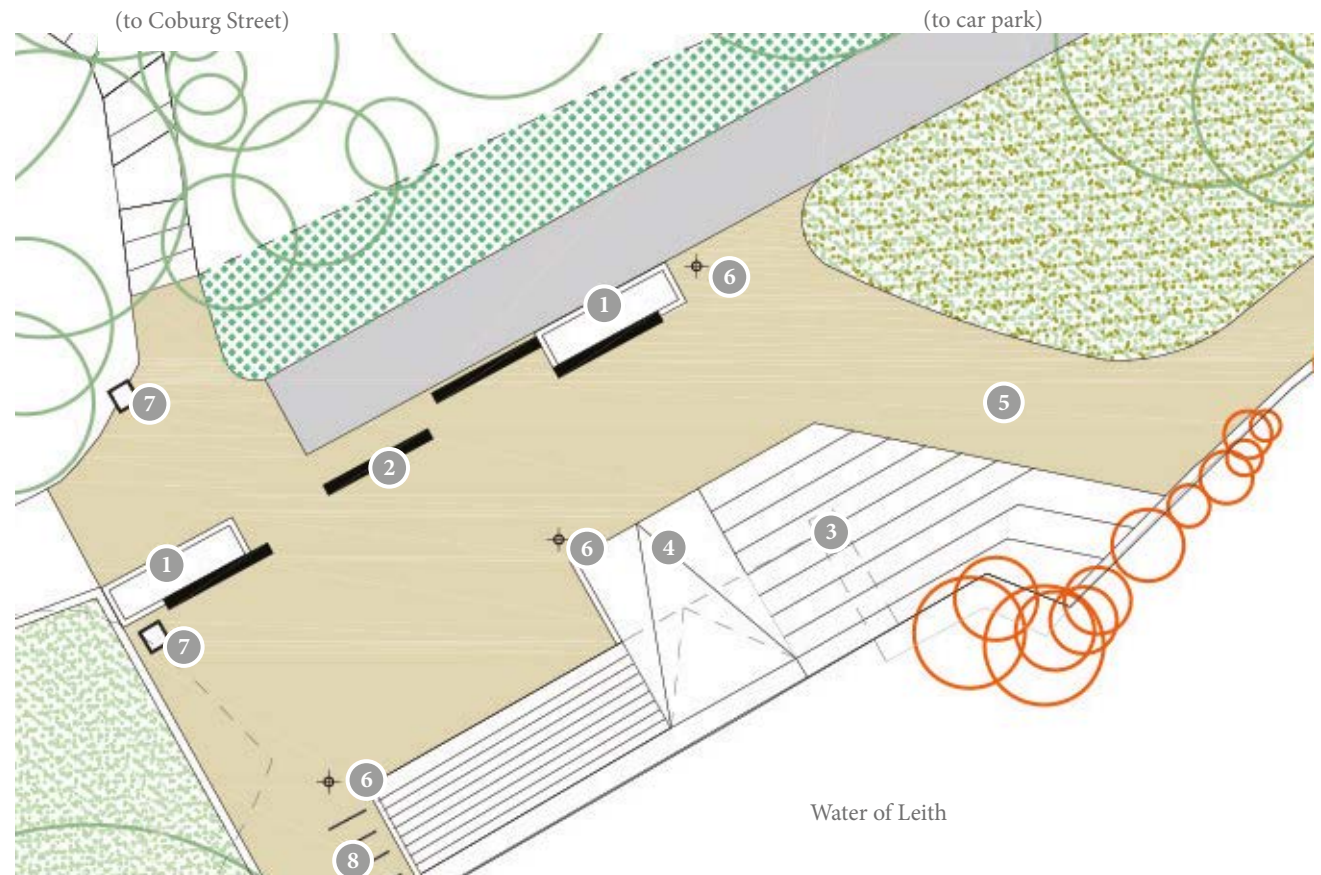

^ N 1:250 (A4 printed pages)

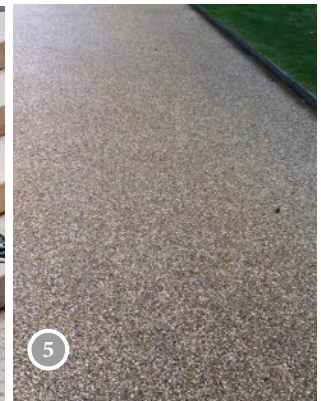





Existing



Proposed



### 3. PICNICS AND PLAY SPACE

A 'wild garden' and mown grass space to the side of the main gathering area for picnics and nature play. The existing overgrown grass and brambles could be cut back, retaining the trees and some of the understorey, but carving a greenspace out next to the more formal riverside gathering space, to create an area for children to explore and play in nature. This outdoor learning opportunity should be designed in detail with input and engagement from local primary school children.

1. Amenity mown grass area for picnics and informal outdoor classroom or other learning opportunities.
2. Up-stand edge to elevate the area by one step (200mm), setting this area apart to discourage short cuts and to dogs by defining this space. Upstand tapers to the west, ensuring a min. 3m wide area with flush access onto grass area.
3. Evergreen structure planting added as a backdrop, adding to the year-round biodiversity value by varying the plant species present, include thorny species such as hawthorn and blackthorn to discourage access to underside of bridge structure. Trim as low hedges (1m high) to create a greenspace backdrop.
4. Signage about the water fowl, including information about what is good to feed the ducks.
5. Community bird feeder, re-purposed metal structure similar to railway heritage feature in the Figgate Park, Edinburgh.



Install some fun play sculptures, celebrating local natural heritage or historic context.

Details to be developed through community workshops with artists or led by local organisations, to develop briefs which reflect public interest and local history.



A community bird feeder, such as the one installed at Figgate Park, which is made from train wheelset. It is a link to heritage and a strong, robust landscape feature.



Collaborate with local nurseries, schools and Forest School leaders to create an active programme of use of the site, establishing this as a child / family friendly environment.





## 4. COMMUNITY GARDEN / SKATE HANG OUT

Throughout the development of this landscape masterplan, the team has been in contact with Scottish Water regarding the status of the brick structure near the Great Junction Street Bridge.

Its ownership is not confirmed, however it is believed to be redundant. The removal of this structure would be costly, and instead there is an opportunity not to remove the brick structure but rather the incorporate it into a new purpose - to create growing areas, to terrace with planters, and to wrap a new concrete form skate / teen hang out seating onto and around the structure.

A space which combines two very different uses, intensity of activity, and users of the space ultimately makes for a safer environment, where these different users are given space and who overlap. Social sustainability comes from layering up these uses, and ensuring many eyes on the ground.

1. Concrete formwork built onto and around the existing brick structure. Skating structures, designed in detail in partnership with Edinburgh Wheels, who have input to the development of this park improvement plan. The skate structures / paths would be constructed as a design and build partnership with Edinburgh Wheels, who provide opportunities for unemployed youths to build paths and plazas. Designs would be developed with the Council's Play Team to ensure compliance with safety standards. In past Edinburgh-based projects, Edinburgh Wheels has diverted and used excess concrete from other construction projects, and this could be done for Coalie Park to ensure a low-carbon, waste efficient construction at this project.
2. Hang out space, platform / informal seating in an amphitheatre form, designed as a teens social space. 3-sided, and create a raised 'stage' area with seating facing inwards: talking, music and dance.
3. Planting by community, local project partners, and WoLCT volunteers. Species choices could focus on plants appropriate for use in rainwater planters, with interpretive signage, giving people ideas for planting for climate resilience and adding biodiversity to urban landscapes. Raised brick retaining planters, with a reservoir base, to reduce need for watering while attenuating rainwater runoff from the upper hard surfaced area as a SuDS strategy. Planting with the community will help to make the space feel safe and cared for.
4. Remove sections of handrail, which increase the perceived height of the structure, where planters are attached and therefore reduce the free-fall height to two levels of 600mm. The detailed design should ensure that the raised planters provide the same level of safety as the open handrail currently offers.



^ N 1:250 (A4 printed pages)

5. Truncate dead-end space towards the bridge and plant for wildlife and biodiversity. Native woodland scrub species such as Hawthorn, Blackthorn and Holly.
6. Resurface top of structure with same bound aggregate material, to mark this out as a community space and create a smooth, even, accessible surface.
7. 3x new bike racks installed, stainless steel 'Sheffield' design.

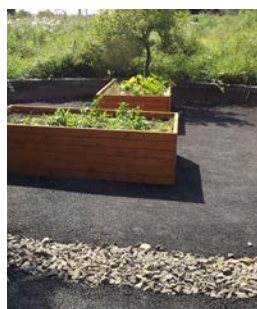



## 5. COMMUNITY ORCHARD

Forging greenspace links and reinforcing connections with adjacent parks and greenspaces, a community orchard is proposed for Keddie Park. This is an underused park and yet presents a valuable greenspace, extending the scale of Coalie Park. This would fit in with Edinburgh's recent Food Growing Strategy.

Many users of Coalie Park are not aware of Keddie Park, or don't make the connection. A community planting initiative could bring this space into more active use, and the clearer link between the two spaces strengthens each as a park with its own functions and character.

A project could be delivered in partnership between ELGT and the Council's Parks and Greenspace Officer, through the 'TreeTime' initiative which is about planting trees for climate resilience and biodiversity. Funding could also be sought from the City of Edinburgh Council's Million Tree City initiative.

The design, layout and number of trees appropriate to the space, its scale and current use should be designed with the local neighbourhood, interest - and school groups' involvement.





## 6. THE STORY OF WATER

A small space formed on the lower walkway route, creating a destination at the west end of Coalie Park. This area is designed around a CSO (Combined Sewer Overflow) which is due for upgrading works by Scottish Water in 2027 so a radical redesign is not proposed at this time.

1. Pipes and Sewers interpretation story, use the brick walls as a canvas for interpretive installation - sharing the history, infrastructure and issues facing urban water management, design and planning. Messaging around responsibility and action. Content and design to be developed by WoLCT in partnership with a local interest group/s, to touch on:
  - Water Quality: the River's journey and human waste (relate to sewer network and our impact on it)
  - Geography: tidal extent, silt, water ebb and flow,
  - History: coal depot, railway lines and stations, mills, ship building and repair.
2. Resurface this area to brighten and set this area apart as a destination space, with views up and down the Water of Leith and a space to stop on the walking loop route. Along pathway, re-set any lifted cobbles.
3. Install new handrail at steps linking upper and lower paths, stainless steel painted black to match all Coalie Park railings.
4. One LED lighting pole, with appropriate colour filter to reduce impact on nocturnal species, located on axis of steps as a subtle beacon on the walking route improving sense of safety and security. Designed and installed to the Council's adoption standards to ensure ongoing maintenance.
5. Sections of trellis on brick retaining walls to grow climbing plants e.g. Honeysuckle, which won't damage the structure. Adds to the biodiversity of this area of Coalie Park, and emphasises the greenspace character. Consult Council's structures team.
6. Removal of Invasive Non-Native Species, notably Buddleia, from the walls, and commission an engineer's report on the stability of the river wall. Details on P39.
7. Install new benches to replace existing; collaboration with Citadel Youth Group to renovate former railway benches, painting with thematic colours / logos to tie in with LeithLate graphics / installations.
8. Street art opportunity on existing brick walls
9. Build a planting area within a triangular drystone wall, planted with native woodland groundcover species.

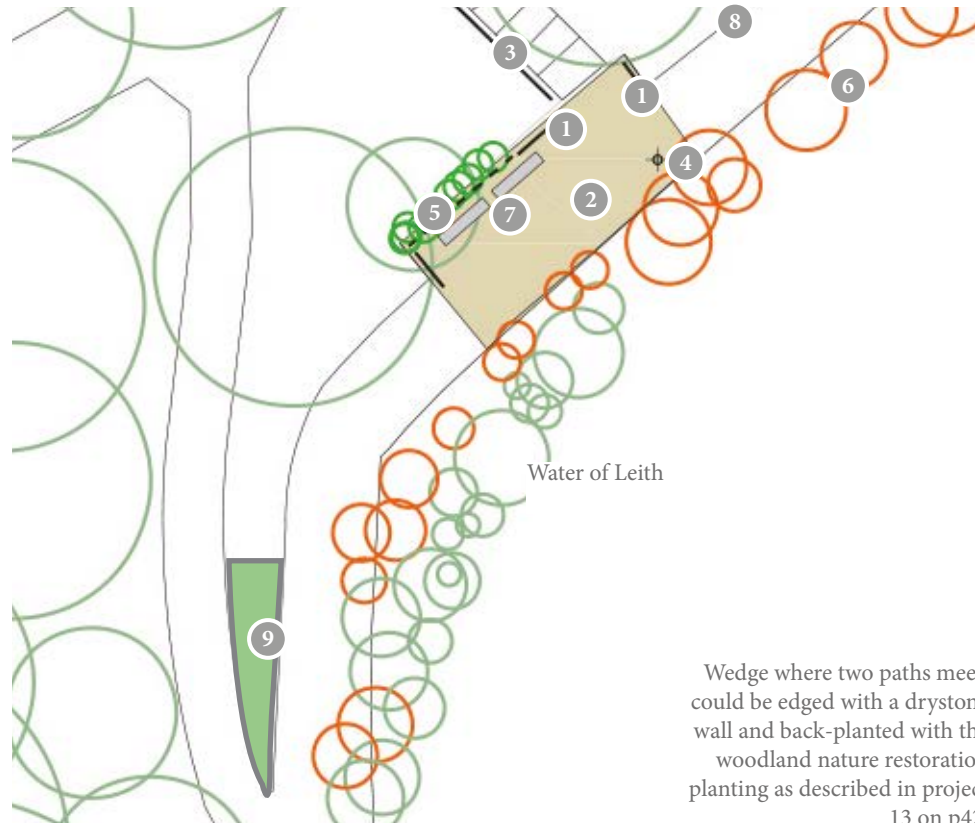

^ N 1:250 (A4 printed pages)

Wedge where two paths meet: could be edged with a drystone wall and back-planted with the woodland nature restoration planting as described in project 13 on p42.

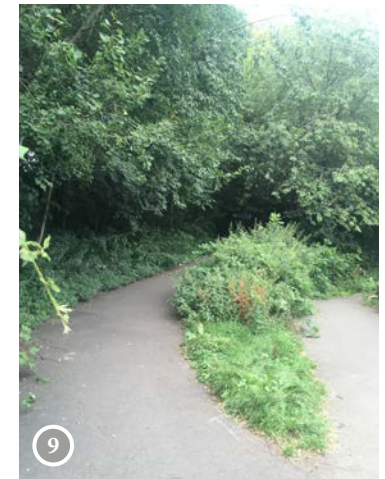

Street art on the brick walls; with replacement benches, painted railings and invasive species removal this walkway could be an interesting, beautiful urban setting.



Explore different methods of interpretation, from attached panels to the brick structures to direct graffiti painting. The detail, design and story-telling brief should be fully developed as an engagement process involving the local community.



## 7. LARGO PLACE SEATING + ART

A key project partner throughout the landscape masterplan development has been LeithLate, with representation throughout the engagement and consultation period, inputting context and background, and keen to partner on delivery of ideas going forward.

Leith Late has developed a proposal for a project called the 'LeithLine' a new public art trail along the Water of Leith Walkway stretching from The Shore to the old Leith boundary at Newhaven Road. The trail would consist of existing art installations (Gormley, poetry stones) alongside newly commissioned artworks, and would be delivered incrementally as funding and resource is secured.

Priority will be given to new commissions within the Coalie Park stretch of the Water of Leith as part of the Coalie Park Improvement Project. One of these interventions is for a seating and art intervention at the point where the steps from Largo Place transect the Coalie Park walk / cycleway, and could interpret the WW2 bomb and its damage, and the impact on local townscape and heritage.

LeithLate identified a location at brick structure where the existing dilapidated brick benches are located for a design and art project building on the existing infrastructure with multi-level seating, public art and informal space for pop-up outdoor performances.

1. Detailed plans for this space could tie in local social history projects including the Spirit of Leithers, SOSLeith and the Old Leith Rediscovered Project. At the scale and scope of a site masterplan, the project team consider this site a strong site for installation, and a detailed brief should be developed and curated by LeithLate. The WoLCT and LeithLate would partner on this development and delivery process. An early idea is to introduce colour using a product such as 'Ironlak' Sugar spray paint, an environmentally-friendly, non-toxic spray paint.
2. Install new benches to replace existing; collaboration with Citadel Youth Group to renovate former railway benches, painting with thematic colours / logos to tie in with LeithLate graphics / installations.
3. Removal of Invasive Non-Native Species, notably Buddleia, from the walls, and commission an engineer's report on the stability of the river wall. Details on P39.

(from Largo Place)

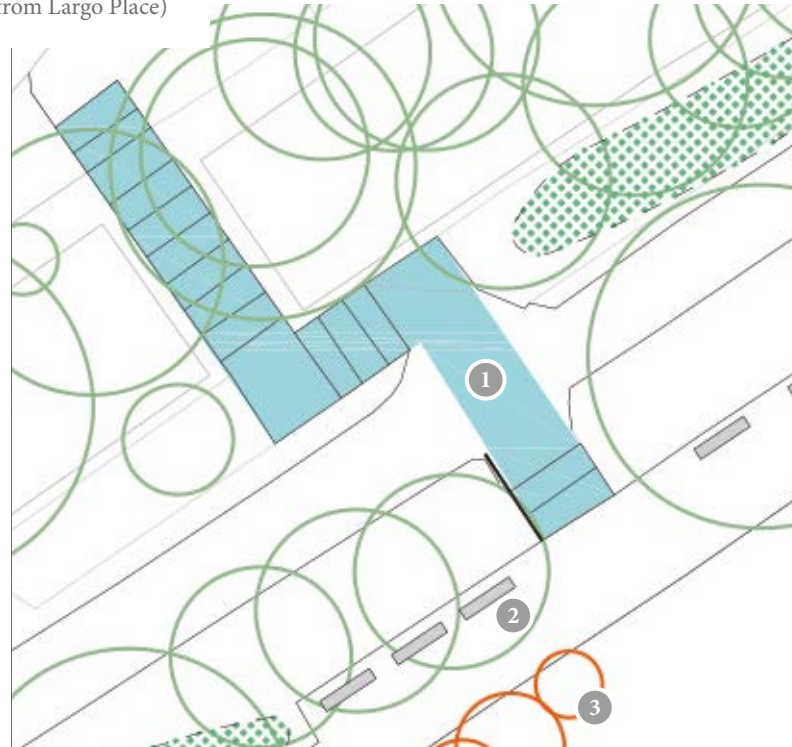

^ N 1:250 (A4 printed pages)



Steps from Largo Place



Steps to riverside path



"LeithLine  
Will be a new public art trail consisting of existing artworks alongside newly commissioned contemporary art installations.

LeithLine will be a key element of the Coalie Park Improvement project, enhancing the Water of Leith Walkway for local communities and regular users of the Walkway, as well as serving as a driver for new visitors to engage with the route

Some artworks will provide intimate moments for people to pause and reflect on their surroundings, while other artworks will be large scale and bold in design reflecting Leith's dynamic independent spirit."





## 8. LEITHLATE UNDER-THE-BRIDGE PROJECT

LeithLate also identified the area under the Great Junction Street Bridge as a space which could be transformed with a public art project, as another installation on the LeithLine trail. This is directly on the Sustrans NCN 75 path, and there's an opportunity to deliver a project in this space with support from the Sustrans ArtRoots Fund.

The City of Edinburgh Council structures team welcome improvements reduce the incidents of vandalism at the site, and should be consulted regarding any proposals for new attachments to the bridge superstructure or substructure such as additional lighting or art installations.

The LeithLine approach would be an evolving project that develops incrementally as funding and resource is secured, through fundraising grants and sponsorship. The trail will be curated by LeithLate in partnership with the Water of Leith Conservation Trust. As part of this wider vision, the area under Great Junction Street Bridge is an exciting yet sensitive site, and this project should be co-produced in detail with LeithLate as local knowledge, expertise and connections are reinforced. A detailed proposal and implementation plan may be developed in partnership with Water of Leith Conservation Trust, bringing together a collaboration of artistic installation and heritage interpretation. Furthermore, this project could link with the nearby Leith History Mural, informing the briefing for this public art element. Delivery would be through a commissioned freelance producer, acting as project manager, who would work with the commissioned artist. This briefing, development and delivery process would be overseen by the LeithLate board of Trustees.



## 9. POETRY CORNER PROJECT

1. Upgrade path surface between on the active travel route with a new layer of bituminous macadam to remove trip hazards and identify different zones.
2. Upgrade path surface on the 'slow' riverside route with resin bound natural stone gravel.
3. Install in-ground solar powered LED uplighters flush into new path surface along slow route.
4. Set the Poetry Stones into this new paving surfaces, flush, and position to form a 'gateway' into the slow route.
5. Paint railings black.
6. Cut back the tree canopy at the Poetry Corner.
7. Remove benches from this convergence point between walkers and cyclists and widen path where they meet. Improved and inclusive seating options are provided along the riverside walkway.
8. 1x lighting column, to use energy efficient LEDs, located on sightline from the car park and helping define this corner. Install with a colour filter to limit impact on nocturnal insects. Designed and installed in agreement with street lighting at the Council, for ongoing maintenance.

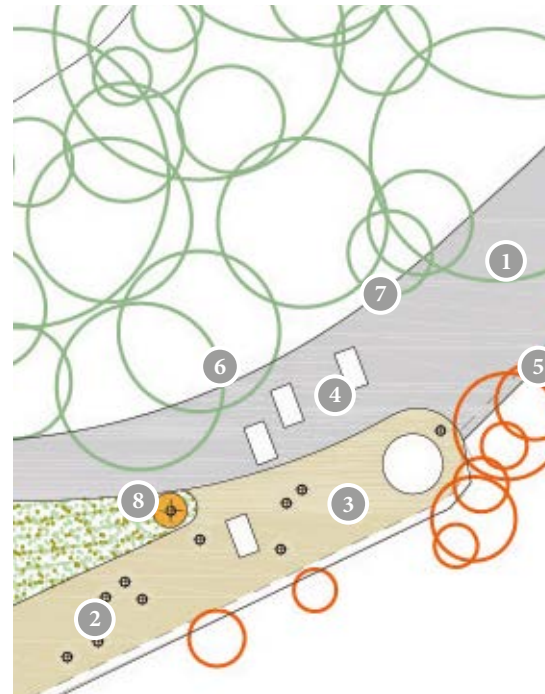

^ N 1:250 (A4 printed pages)





## 10. WOODLAND MANAGEMENT

The woodland setting which defines Coalie Park is a much loved and valued part of what makes this place special, and in this densely populated urban area it is a critical resource supporting peoples' health and wellbeing.

The quality and coverage of the woodland should be retained and protected as other developments, improvements and construction projects may take place. A light touch approach of positive tree and woodland management is promoted, e.g. selective trimming where tree branches impede pedestrians / cyclists, or to optimise biodiversity and understorey layers of diverse plant species.

A woodland condition survey is recommended in support of this management planning. WoLCT has liaised closely with Council Officers (Natural Heritage, and Parks & Greenspace) to understand what works are planned, and how Ash Dieback is being managed in this greenspace.

1. Selective trimming of overhanging boughs of Sycamore where these are impeding the active travel route.
2. Selectively lift crowns of the Lime trees in double avenue to lift canopy, allow in more light, and reduce low hanging branches. Enhance sense of safety within park environment, and encourage greater species diversity in understorey.
3. Bulbs and evergreen woodland shrub species to diversify woodland areas and enhance habitat mosaics (see p42).
4. Reduce area of brambles around Willow cluster to create a greenspace which can be planted up with a mixed native hedgerow containing nut and berry species (e.g. Dog rose, Hazel, Sloe, Blackthorn) which would form a backdrop to this greenspace.
5. Protect Cherry tree in place, on mud banks, as an important feature introducing the park setting and offering cover and food source for birds and insects.



^ N [NTS]

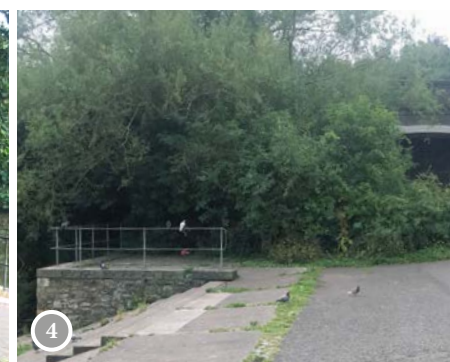
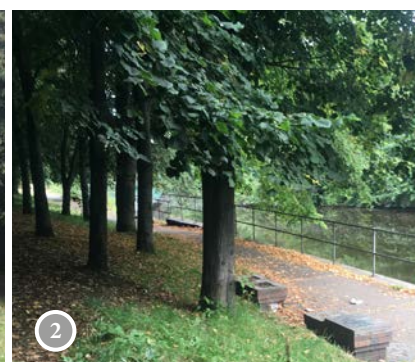
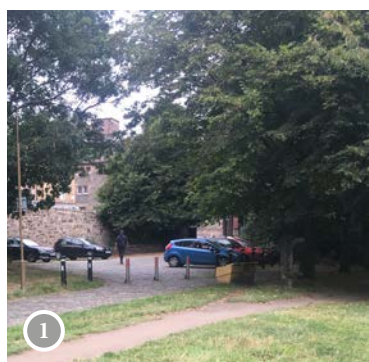



## 11. INVASIVE NON-NATIVE SPECIES MANAGEMENT

The location of Buddleia, an Invasive Non-Native Species (INNS) has been mapped and recorded as a detailed digital survey, and analysed to prepare a 'heat map' identifying areas of priority for treatment and removal.

A contractor has been engaged with to determine scope, costs and the potential for volunteer engagement as part of the management works. Organised and overseen by the WoLCT, volunteers could be involved in the active management of INNS, for Buddleia as an first stage project with the mapping and scope already known, and then for subsequent species of concern for nature restoration such as Himalayan Balsam and Giant Hogweed.

The Buddleia removal is also a first priority due to the damage to the structural integrity of the river bank and stone walling. Methodology for removing the Buddleia is being developed to ensure that the structural walls are protected and left in a safe condition, and should be agreed with the Council. Any works to remove the Buddleia will be agreed with the Council or appropriate landowner prior to works being undertaken.

The potential to enhance habitats and to engage the public in nature restoration should be fully explored, as a means to connect individuals and interest groups with the hands-on management of the riverside landscape.



Volunteers help undertake INNS management work



Buddleia location heat map - detailed digital survey undertaken by WoLCT

0 75 150 m



## 12. BIOMATRIX

### BIOMATRIX

Floating ecosystems are anchored to the banks of water courses, and there is an opportunity at the Water of Leith to install a Biomatrix as a habitat restoration project.

- Installed on the south banks of the river basin, a location shown on the photograph below. As a habitat enhancement project, a quiet, undisturbed site was identified, where fish and waterfowl can flourish.
- The installation is a floating modular ecosystem, by Biomatrix Water, using sustainable non-toxic materials to enhance water habitats through increased water's edge surface area, providing a safe haven for birds, and sub-surface shelter for fish.
- This habitat enhancement project also aims to improve water quality and human connection with the water.
- Anti-social behaviour is unlikely due to the natural vegetation which forms this riparian edge, discouraging access due to the wet and muddy substrate and dense planting.
- Biomatrix Water would propose to engage with local groups and residents, to find ways to get the local community involved in the maintenance of the floating ecosystems. Participation can be promoted at installation days, where local groups can join the contractor in the installation and launching of the ecosystem.







Biomatrix Water location visualisation

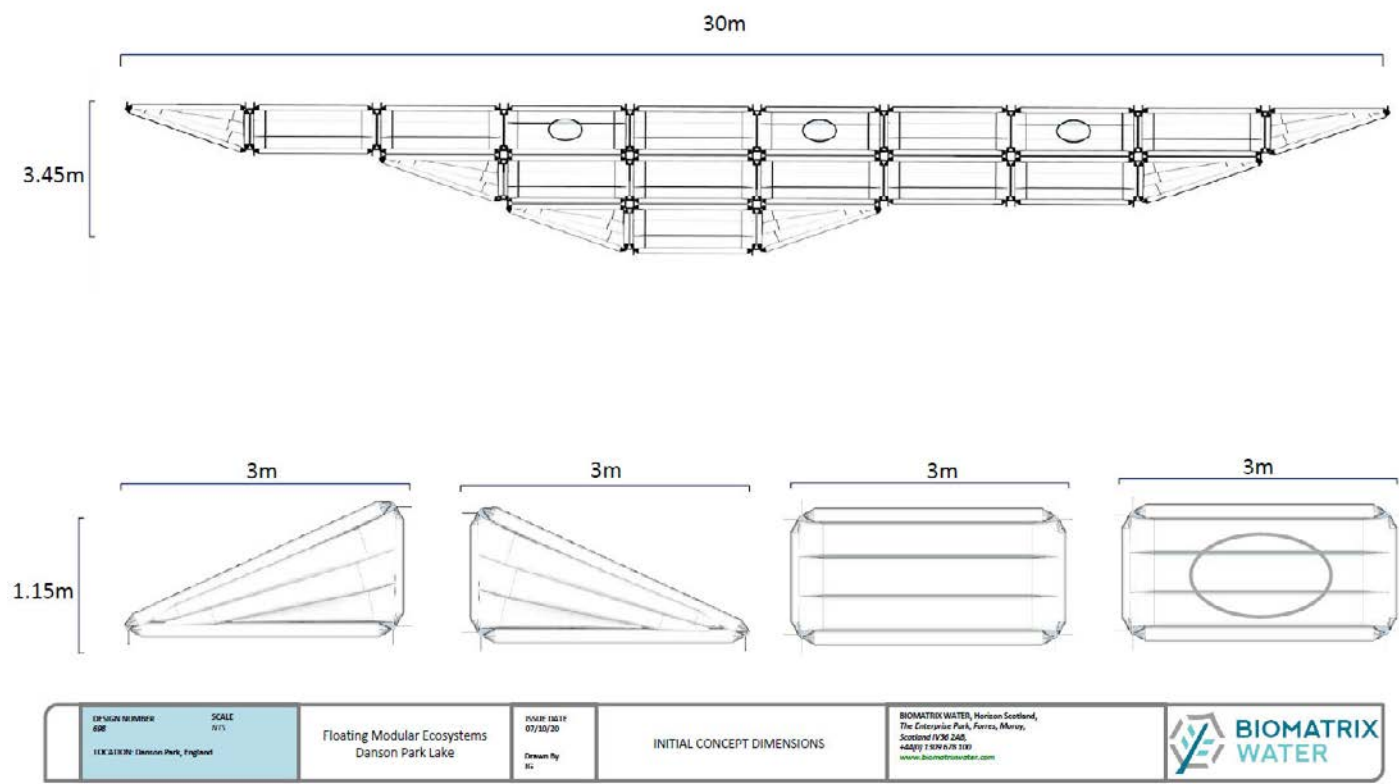

Biomatrix Water diagrams and component details



## 13. BIODIVERSITY PLANTING

The south facing slopes could be planted with bulbs and managed for diverse wildflower grassland. In particular, these areas could be planted with species to attract and feed pollinators, which the Buddleia currently offers yet which is causing significant damage to the river walls.

Bulb planting was already started at Fun Day event as a way to engage the public and show direct action. A mixture of WoLCT volunteers and students from The University of Edinburgh cleared leaves, cut back vegetation and added 300 plants to the verges at this event. Already planted are:

- Snowdrops and bluebells
- Winter aconite
- Wild daffodil
- Teasel
- Selfheal
- St John's Wort
- Tansy
- Yarrow
- Ox-Eye Daisy
- Red Campion
- Knapweed.

Any gaps in the tree canopy or less heavily shaded locations could be planted under with more bulbs or wildflower plug plants. Plants should be native, and pollinator species prioritised e.g.

- Geum urbanum (Wood Aven's)
- Blechnum Spicant (Deer Fern)
- Asplenium Scolopendrium (Hart's Tongue Fern)
- Lungwort (Pulmonaria officinalis)
- Wood Sage (Teucrium scorodonia)



Mix 1 - shaded woodland floor

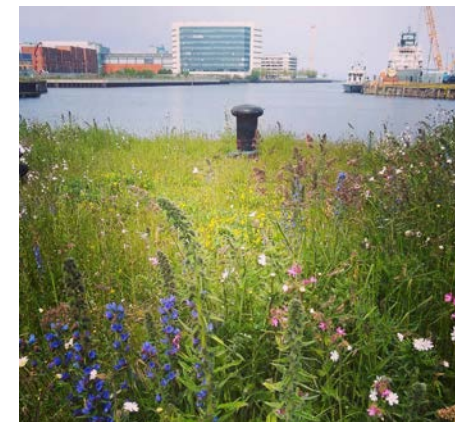

Mix 2 - Edinburgh shoreline mix / urban pollinator mix



WoLCT and University of Edinburgh volunteers at the Coalie Conversations 'fun day' event in October, 2021



## 14. SLOW SPACE AND SEATING

A light-touch alteration to this space, where the main issue is the conflict of different speeds of user. Commuting or leisure cyclists want to move through the space at speed while walkers and families have an opportunity here to experience the riverside up close.

The design proposal focuses on clarity of two routes for different park users: an upper route for cyclists and a riverside route for walkers.

1. Upgrade the entire path surface between the new 'gathering space' (project 2) and Sandport Place to remove trip hazards. This accessible route will be re-surfaced with resin bound material.
2. Install in-ground LED solar powered lights flush with the new paving surface. These have been used with positive feedback from users at the Union Canal in Edinburgh, where tow path users say they feel safer using this as an active travel route throughout the year. They do not provide high levels of light, but are useful in marking the route and making the space feel safer.
3. Replace existing brick seats with 5x Edinburgh street furniture standard stainless steel benches, painted black. Push the benches back into the grassy area to keep the walking route clear. These benches with backrests and arm rests are suitable to increase the usability of the public space for older people. The Disability Discrimination Act recommends a minimum 400m spacing of seating opportunities in public spaces.
4. Paint railings black.

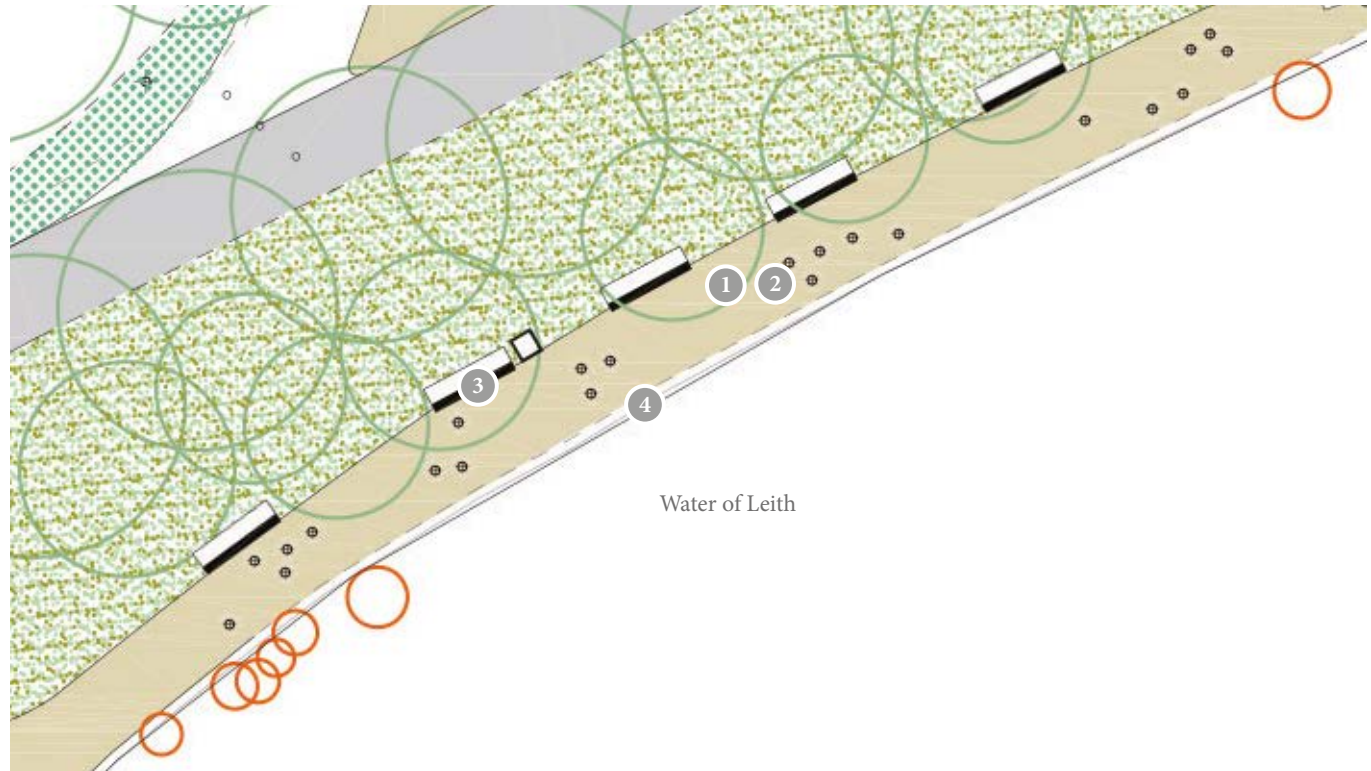

^ N 1:250 (A4 printed pages)



1



2



3



## 15. MOVING THROUGH COALIE PARK

Coalie Park is both a stopping place and a route people use to pass through to get to places, a healthy clean greenspace offering an alternative commuting route. It is identified in the work of the Leith Connections Project, which looks at cycle routes and placemaking in Leith, and identifies Coalie Park as an important link in the wider connection network.

Leith Connections explores how to encourage cyclists to use the road rather than the riverside route, and looks at how the streetscape can be redesigned to make cycling on streets a safer and more attractive option. The Coalie Park design process was mindful of the engagement and feedback gathered on the online storymap: <https://storymaps.arcgis.com/stories/319c706abb224968b1eb20c3496c4377>.

Within the park, the objectives of the fast route / slow route approach described by Leith Connections is supported through clarity of the NCN 75, limiting conflict points such as at the gathering space and the car park / entrances, and making users more aware of each other.

1. The 'fast' route (>4mph - cycles, scooters, runners) is recognised as the northern 2.5m width of pathway (against the railway wall). It is currently surfaced in 'blacktop', bituminous macadam, and this smooth surface indicates the faster route. Where this route is extended to pass along the south of the existing car park area, the path surface should continue this bituminous macadam surface.
2. The 'slow' route (<4mph) runs next to the riverside, predominantly using the 'lower' path route. This surface is currently in poor condition, and it is proposed to top this with a resin bound natural stone aggregate top coat.
3. Using an environmentally friendly spray paint such as Ironlak Sugar spray paint, graphic typography could be used to indicate distances or features of local significance for example for heritage features, or to highlight where steps and pedestrian routes intersect the main east-west route.
4. Install in-ground solar powered LED lights flush into existing path, at dark section adjacent to the North Leith Burial Ground.
5. 4x new stainless steel benches positioned where space allows, and set back into managed vegetation along section between Coalie Park and Sandport Place.



Ironlak sugar spray paint, or similar non-toxic environmentally friendly surface marking paint



Graphics showing routes, information such as distances and directions



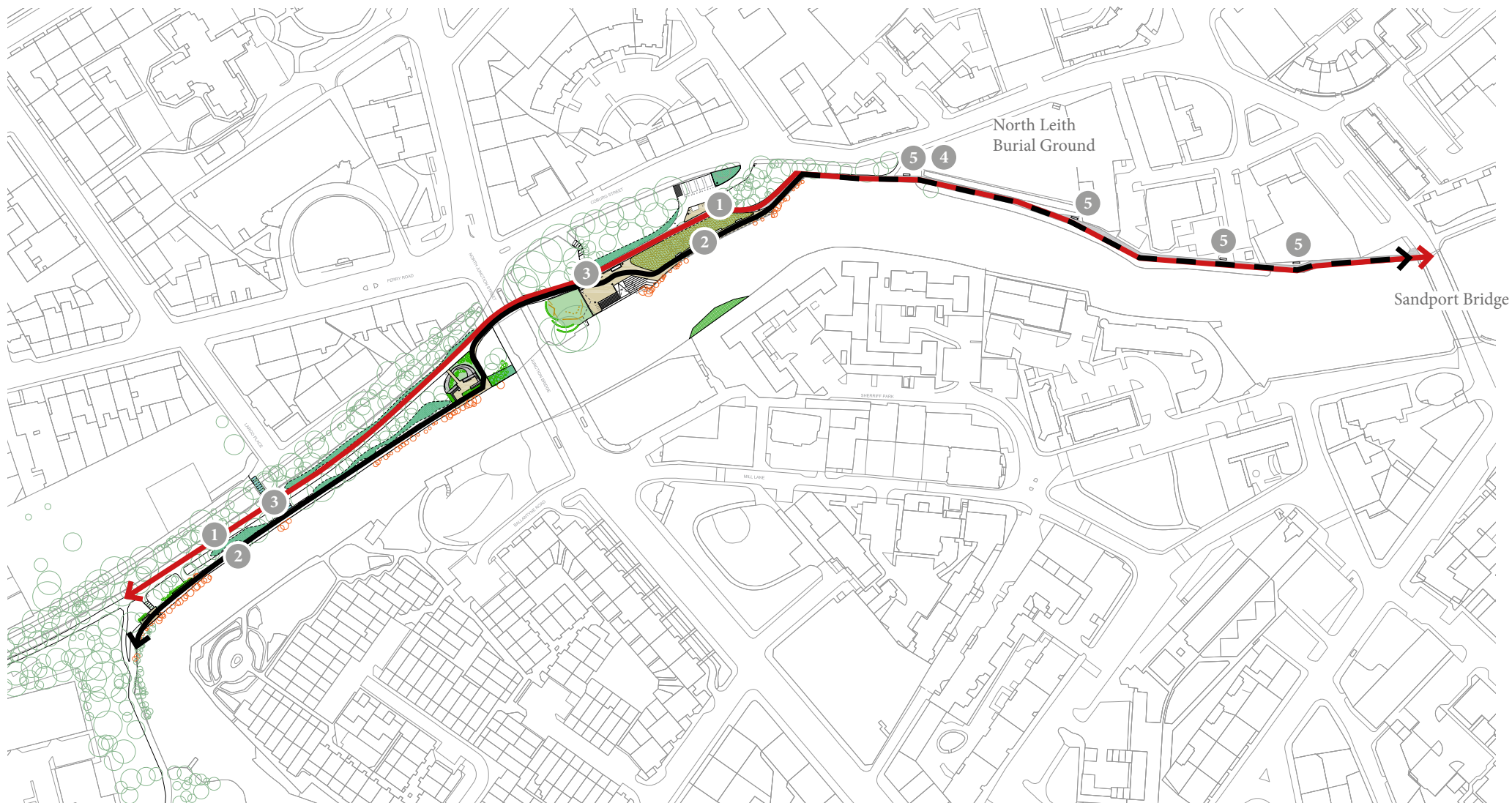

^ N 1:2000 (A4 printed pages)

**Red line:** 'Fast' route - predominantly cyclists. This isn't a marked route, rather it is implied by the surfacing and directness of route.

**Black line:** 'Slow' route - focus all seating, bins, bike racks, interpretive features, along this route





*Thank you very much for the chance to read and comment upon this project so far. There are many wonderful proposals, with the potential to really improve on this well-loved space. It's great also to see the level of engagement with community stakeholder groups."*



*Thank you for Monday's meeting. It was really useful to hear about the full masterplan and to hear feedback from the other Coalie Collective contributors."*

DELIVERY AND IMPLEMENTATION APPROACH

# WHAT'S NEXT ?



*The idea of mixed uses is essential to create a safer, more accessible space for everyone"*



*Well done with all the progress with the project!"*



*Just a quick email to say how much I enjoyed this morning's meeting and what a great project you are starting. I'm really looking forward to seeing how it progresses."*



## DELIVERY AND IMPLEMENTATION APPROACH

The finalised Coalie Park Improvement Plan will form the basis of next phases of the project. This will see the implementation of a community led project to deliver place improvement for citizens and nature in Leith. It includes 5 placemaking projects, 800m<sup>2</sup> path upgrading, 4 arts / interpretation installation and restoration and management of nature habitats in the water and woodland areas

The Water of Leith Conservation Trust plans to work with various departments and officers at the Council to steer the project through the following next steps:

- Landowner permissions and consent for all aspects of the project will be sought
- An application for Planning permission will be submitted to City of Edinburgh Council
- Outline quotes for the overall work and individual project will be sought to guide funding applications
- Funding applications submitted
- Any specialist surveys conducted – such as tree and woodland and ground services
- Detailed Design Development work will produce plans, details and material schedules for the more technical projects within the plan such as the Gathering Space and Community Garden / Skate hangout
- Tendering and detailed quotes for works will be obtained
- Funding secured and a schedule of implementation agreed with all parties.

As evidenced in the Coalie Conversations engagement process, and the range of interest this improvement plan development has attracted, there is a huge amount of will and support for this project but as yet no funding has been secured so a time frame cannot be included at this stage.

The Water of Leith Conservation Trust is open to any offer of help both financial and in kind, which would be gratefully received.

## CONTINUING THE CONVERSATION

Coordination with the Coalie Collective should continue, through constructive partnership working. In particular, Citadel Youth Group / Edinburgh Wheels should be involved in further follow-up engagement sessions, with children and young people to help inform the designs proposed for the play and teenage areas, as well as the entire park.

CATEGORY	TIMESCALE	PROJECT	NEXT STEPS	PARTNERS
Nature Restoration	Year 1 (outwith bird nesting season)	⑩ Woodland management	- Liaise with trees and woodlands officer at the Council on next steps, and current management plans. Leave felled boles on site for habitat	- Council - Trees & Woodlands - WoLCT
	Year 1(outwith bird nesting season)	⑪ Invasive non-native species management	- Identify all landownership and permissions - Confirm methodology with landowners - Implement works with volunteer involvement	- WoLCT (with contractor) - Council - Natural Heritage
	Year 2	⑫ Biomatrix	- Landowner approvals - Confirm and appoint Biomatrix Water install	- WoLCT - Riverbank landowners
	Years 1-3	⑬ Biodiversity planting	- Continue programme of planting for biodiversity with WoLCT volunteers	- WoLCT
Placemaking	Year 2	① Car park and entrance space	- Fundraise for and commission detailed design of entrance space layout for planning permission - Coffee Trailer licence - Engage with Dry Stone Walling Association	- WoLCT - Council - Parks & Greenspace - Council - Active Travel Team - Coffee Waves
	Years 1-3	② Gathering space	- Scope reports and studies required, including civil engineering feasibility study - Fundraise for design development, to permissions and tender package.	- WoLCT - Council - Parks & Greenspace
	Year 1	③ Picnics and play space	- Volunteer gardening day, with groundworks by the Council's Parks / Natural Heritage teams.	- Parks & Greenspace - WoLCT
	Years 1-3	④ Community garden / teen space	- Confirm findings of Scottish Water survey - Funding applications for design work - Scope permissions required - Scope studies / reports required - Coordinate with Council's Water Vision project	- Council - Parks & Greenspace - WoLCT - Leith Community Croft - Edinburgh Wheels (skate)
	Year 1	⑤ Community orchard in Keddie Park	- Identify site for community orchard - Design layout with local school/s - Planting event with local children	- Council - Parks & Greenspace - ELGT - Million Tree City initiative
Movement and Active Travel	Years 1-3	⑭ Slow space & seating ⑨ Poetry Corner	- Detailed design & planning application - Funding application/s for capital works, e.g. Sustrans 'Places for Everyone' funding	- WoLCT - LeithLate - Sustrans
	Years 1-3	⑮ Moving through Coalie Park	- Develop Sustrans partnership around placemaking on the NCN75 route, and apply for 'Places for Everyone' funding	- WoLCT - Sustrans - Council Active Travel Team
Art and Interpretation	Year 2	⑥ The Story of Water	- WoLCT engagement and events to develop interpretive content. - Fundraising for heritage interpretation - Appoint outdoor education graphic artist.	- WoLCT - Scottish Water
	Year 2	⑦ Largo Place (LeithLine) ⑧ Under the bridge installation (LeithLine)	- LeithLate to develop briefs - Design, methodology and implementation agreed with the Council's Structures team. - WoLCT and LeithLate funding applications for implementation.	- WoLCT - LeithLate & local artist/s - Citadel - reclaimed benches



---

A PROJECT DEVELOPED BY

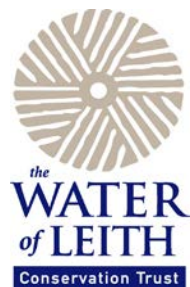

•EDINBURGH•  
YOUR COUNCIL - YOUR ENVIRONMENT



---

REPORT PREPARED BY



---

PROJECT SUPPORTED BY

